



30th Anniversary of
ASHRAE HONG KONG CHAPTER
1984-2014



30th Anniversary Dinner

on

14th April 2014

at

Grand Ballroom, Kowloon Shangri-la Hotel



TABLE OF CONTENTS ◀

▶ **30th Anniversary of ASHRAE Hong Kong Chapter. 4-9**

Message from President of ASHRAE Hong Kong Chapter
 Message from President of ASHRAE
 Message from Region XIII DRC
 Message from Chair of the 30th Anniversary Celebration Organizing Committee
 List of 30th Anniversary Celebration Organizing Committee & Editorial Committee Members

▶ **About ASHRAE. 10-15**

ASHRAE is...
 Mission, Vision and Values
 More...

▶ **About Region XIII. 16-29**

History of Region XIII
 ASHRAE Region XIII 2013-2014 Regional Executive Committee
 Message from Mr. Vincent K C Tse
 Message from Mr. Raymond Y W Wong
 Message from Dr. C S Ow
 Message from Dr. Robert Y Z Hu
 Message from Mr. Wichai Laksanakorn
 Participation of Hong Kong Chapter
 Singapore Chapter
 Malaysia Chapter
 Taiwan Chapter
 Philippines Chapter
 Thailand Chapter
 Indonesia Chapter

▶ **About Hong Kong Chapter. 30-49**

History of Hong Kong Chapter
 Milestone of ASHRAE HK Chapter
 The Chapter's Organization
 Officers, Governors and Working Committees (2013-2014)
 List of Fellow and Life Members
 List of Honors and Awards of Hong Kong Chapter
 Student Branches

▶ **Past Presidents' Message. 50-61**▶ **ASHRAE Hong Kong Chapter Future Leaders. 62-67**▶ **ASHRAE Hong Kong Chapter Life. 68-79**▶ **Sponsors. 80-99**



30th Anniversary of ASHRAE Hong Kong Chapter

- Message from President of ASHRAE Hong Kong Chapter
- Message from President of ASHRAE
- Message from Region XIII DRC
- Message from Chair of the 30th Celebration Anniversary Organizing Committee
- List of 30th Anniversary Celebration Organizing Committee & Editorial Committee Members

30th ANNIVERSARY OF ASHRAE HONG KONG CHAPTER



Message from
Ms. Tracy C M Pang
President of ASHRAE Hong Kong Chapter

In 1984, there was a group of local engineers who had passion and interested in HVAC&R established the ASHRAE Hong Kong Chapter under the leadership of our founding Chapter President, late Dr. Edwin TAO.

In 2014, there is another group of local engineers who are energetic and faithful to the HVAC&R industry preparing this booklet to celebrate the 30th Anniversary of the ASHRAE Hong Kong Chapter, and it is my honour to be the Chapter President for the year 2013-2014 and be one of the members of this group.

ASHRAE Hong Kong Chapter is a volunteers based learning society, there is no supporting staff, no working office and no remuneration for the committee, but we have a team of engineers to operate the chapter by following the manual developed by the past presidents, to organize the activities for members by sharing some of their treasure moment with the family, to sustain the chapter growth by training up the young engineers with their valuable knowledge. This team forms the "ASHRAE Family" who aims to advance the arts and sciences of HVAC&R to serve humanity and promote a sustainable world.

Training is one of the key factors to keep the chapter to sustain, with our past presidents' wisdom of setting up the first student

branch in 1994 at the Hong Kong Polytechnic University and the formation of Young Members Committee (YMC) in 2003, a channel is provided for the students and young engineers to learn more HVAC&R knowledge from seminars, to exchange the creative idea with the professionals and to develop the leadership skill within the "ASHRAE Family".

The Year 2013/2014 is a very special year, it is my presidential year plus the 30th Anniversary of the ASHRAE Hong Kong Chapter, also the Cantonese pronunciation of "13/14" means "forever" (一世一世), I believe the "ASHRAE Family" will keep growing with your "forever" support!

Last by not least, I would like to take this opportunity to express my heartfelt thanks to the organizing committee for organizing those wonderful celebration events and this booklet to tell us the history of ASHRAE Hong Kong Chapter in the past 30 years. I wish you all enjoy this memoir!

Tracy Pang
 President (2013-2014)
 Hong Kong Chapter

▶ 30th ANNIVERSARY OF ASHRAE HONG KONG CHAPTER



Message from **Prof. William Bahnfleth** President of ASHRAE

As only the second ASHRAE Chapter chartered outside the United States and Canada – in June 1984, a mere six months after Singapore, ASHRAE Hong Kong Chapter holds a special place in the history of the global development of the Society. In a matter of only 15 years following its establishment, Hong Kong became one of the original members of Region XIII, the first ASHRAE Region outside North America. Today, with a membership approaching 900, it is exceeded in size by only India, Canada, and the United States. Through perseverance and hard work, Hong Kong has become not only one of ASHRAE's largest chapters, but also one that very ably carries out our mission to serve humanity and promote a sustainable world by advancing the arts and sciences of heating, ventilation, air-conditioning, refrigeration, and allied arts and sciences. To survive and prosper for 30 years is a significant achievement for the Chapter and I offer, on behalf of all of ASHRAE, my sincerest congratulations. However, as we celebrate this important milestone and the accomplishments of the past, let us also direct our thoughts

to the new challenges that Hong Kong Chapter will encounter as it moves forward and make this happy occasion the starting point of a journey to an even brighter and more illustrious future.

A handwritten signature in black ink that reads "William Bahnfleth".

William Bahnfleth
ASHRAE President (2013-2014)

30th ANNIVERSARY OF ASHRAE HONG KONG CHAPTER



Message from
Mr. Edward K C Tsui
Director and Regional Chair
(Region XIII)

Congratulation to ASHRAE Hong Kong Chapter and the members, on achieving the 30th anniversary.

Thirty years ago, the ASHRAE Hong Kong chapter was chartered with the promise to advance the arts and sciences of HVAC&R to serve humanity and promote a sustainable world. I would like to express my gratitude to the founding chapter president and committee members for their effort and forward-looking.

One of those pioneers and the profound impact the Hong Kong Chapter has made in the 30-year timeline was the formation of Region XIII in 1998, with the joint effort of those leaders from Singapore, Malaysia and Taiwan chapters.

Region XIII is the first ASHRAE region formed outside North America, aiming to better serve ASHRAE members in Asia. Since the formation in 1998, Region XIII grows to seven (7) Chapters, three (3) sections and two (2) groups today.

ASHRAE refreshed the logo and tagline in Feb 2012, to reflect the broadening of its scope from HVAC&R to the total building environment.

Shaping Tomorrow's Built Environment Today, the ASHRAE's new tagline, serves as a promise to members and the industry that whatever the future brings in the built community, ASHRAE will be at the forefront for research and guidance.

I will look forward the new page of Hong Kong Chapter, inline with ASHRAE Mission, Vision and Core Values.

All the best to the members of ASHRAE Hong Kong Chapter as well as Region XIII.

Edward Tsui
DRC (2013-2016)
Region XIII

▶ 30th ANNIVERSARY OF ASHRAE HONG KONG CHAPTER



Message from

Mr. Alan Y W Lam

**Chair of the 30th Anniversary Celebration
Organizing Committee**

On behalf of the Organizing Committee, it is my pleasure to welcome all honorable guests, regional officers and sponsors from different places of the World joining in the great and memorable banquet on 14 April, 2014.

The 30 years of operation the Hong Kong Chapter has been becoming in systematic and successful. This is coming from our sustainable and voluntary team spirit in the Hong Kong Chapter in continuing for serving our members in the Chapter.

In this respect, I would like to thank all members of our committee and other supporters who had contributed a lot on the overall arrangement of the celebration events in the 30th Anniversary, not particularly in the 30th Anniversary Banquet.

Alan Lam

Chairman of 30th Anniversary Celebration
Organizing Committee

30th ANNIVERSARY OF ASHRAE HONG KONG CHAPTER

List of 30th Anniversary Celebration Organizing Committee & Editorial Committee Members

Organizing Committee

Chair

Mr. Alan Y W Lam

Co-Chair

Mr. Vincent T W Chu

Secretary

Dr. C S Wong

Treasurer

Mr. Albert W F Lin

Member

Mr. Joe W H Chow
Mr. Taylor C F Chow
Dr. Roger C Y Chu
Mr. Kenny Y C Lee
Mr. Jacky C K Ng
Ms. Tracy C M Pang
Mr. W K Pau



(From Left to Right)
Mr. Taylor C F Chow, Mr. ALbert W F Lin, Mr. Jacky C K Ng,
Mr. Vincent T W Chu, Dr. Roger C Y Chu, Mr. Edward K C Tsui,
Ms. Tracy C M Pang, Dr. C S Wong, Mr. Alan Y W Lam,
Mr. Joe W H Chow, Mr. W K Pau, Mr. Kenny Y C Lee

Editorial Committee

Chair

Mr. W K Pau

Member

Mr. Taylor C F Chow
Dr. Roger C Y Chu
Mr. Vincent T W Chu
Mr. Alan Y W Lam
Mr. Albert W F Lin
Ms. Tracy C M Pang
Dr. C S Wong



(From Left to Right)
Mr. Taylor C F Chow, Mr. Alan Y W Lam, Mr. W K Pau, Mr. Vincent T W Chu, Ms. Tracy C M Pang, Dr. Roger C Y Chu, Mr. Kevin Leung, Ms. Polly Tsang



About ASHRAE

- 
- ASHRAE is...
 - Mission, Vision and Values
 - More...

ASHRAE is...

ASHRAE, founded in 1894, is a building technology society with more than 50,000 members worldwide. The Society and its members focus on building systems, energy efficiency, indoor air quality, refrigeration and sustainability within the industry. Through research, standards writing, publishing and continuing education, ASHRAE shapes tomorrow's built environment today. ASHRAE was formed as the American Society of Heating, Refrigerating and Air-Conditioning Engineers by the merger in 1959 of American Society of Heating and Air-Conditioning Engineers (ASHAE) founded in 1894 and The American Society of Refrigerating Engineers (ASRE) founded in 1904.

ASHRAE's technical foundation is built by its more than 50,000 volunteer members in 128 countries with more than 170 chapters which are organized into thirteen regions and a region-at-large. ASHRAE members are primarily consulting and design engineers, architects and contractors in charge of services for industrial and manufacturing firms and buildings, including commercial, institutional, government and public utilities.

ASHRAE's committee structure is the mechanism that makes the Society run. Through this structure, members formulate policy, develop procedures, and direct Society activities. Decisions made by the Board of Directors are based on the recommendations of committees. Because of this, the Board of Directors is only as effective and efficient as the Society committees.

New ideas and new programs are usually initiated in committees, which also serve as management training centers for future Society leaders. Those interested in serving on a committee are encouraged to make their wishes and qualifications known. Chapter and regional officers, and others who are in a position to know and evaluate prospective committee members, are urged to submit recommendations for consideration.

Mission, Vision and Values

Mission: To advance the arts and sciences of heating, ventilating, air conditioning and refrigerating to serve humanity and promote a sustainable world.

Vision: ASHRAE will be the global leader, the foremost source of technical and educational information, and the primary provider of opportunity for professional growth in the arts and sciences of heating, ventilating, air conditioning and refrigerating.

Core Values: Our Core Values form the constant foundation which underlies our work and conduct. These values govern our work, interaction with each other and which strategies are employed to fulfill our mission.

1. Excellence: ASHRAE education, technical information and all other activities and products will always reflect best practices through continuous improvement and innovation.
2. Commitment: ASHRAE and its members are passionate about serving the built environment, creating value and recognizing the accomplishments of others.
3. Integrity: ASHRAE is committed to the highest ethical standards. We work transparently, observing essential requirements for due process and peer reviews to do the right things the right way.
4. Collaboration: ASHRAE seeks and embraces collaborative efforts with organizations, agencies and individuals sharing our commitment to sustainable built environments.
5. Volunteerism: Members lead ASHRAE at every level, serving ASHRAE and helping ASHRAE serve society.

▶ ABOUT ASHRAE

More...

ASHRAE Online – www.ashrae.org

The ASHRAE website allows users to access the Society through the internet to obtain information about ASHRAE's activities, purchase products, register for meetings and communicate with staff. Members can access the website to update their member records, pay dues online and access the Abstract Archive and full text of ASHRAE Journal articles. The site features an online ordering and delivery service for standards, guidelines and papers presented at semi-annual meetings. Public review drafts of ASHRAE's standards and guidelines may be downloaded free of charge. Published addenda to standards are posted for free. In 2012, the redesign of web site improved member login, navigability, enhance services to members and simplify the process locating and ordering ASHRAE publications. Members will log in using their e-mail address and a password of their choosing, rather than their member number and PIN.

ASHRAE Research

Since 1919, ASHRAE has supported research to improve the quality of life. ASHRAE Research impacts the industry by improving the way HVAC&R systems work, how they are applied and allow development of technical information to create standards and guidelines, which serve as the basis for testing and design practices around the world. The Society funds thousands of projects addressing topics such as sound, duct design, the effect of oil in refrigerants, load calculations, thermal conductivity, simplified energy analysis procedures, weather data, refrigerant property data, fire and smoke control and solar design. The most significant ASHRAE research is in the areas of human comfort and the properties of materials and systems used in buildings and refrigeration systems.

Research and Your Health

ASHRAE Research is working in the health arena to help:

- Prevent more than 70,000 surgical site infections that occur each year
- Decrease the spread of airborne diseases
- Improving cancer treatment methods

Research in Your Workplace

ASHRAE Research is learning more about how commercial buildings can:

- Conserve energy in hot and humid climates
- Select boilers for efficient heat use
- Allow drifting temperatures to save energy

At Home and At School

ASHRAE Research is:

- Exploring whether temperature and air quality improve the performance
- Understanding the relationship between occupant health and ventilation rates
- Evaluating how food preservation is influenced by storage conditions

A research strategic plan was launched to guide ASHRAE research for the year 2010-2015. The plan outlines ASHRAE's research goals for the year 2010-2015. It centers on sustainability, which is defined as 'the concept of maximizing the effectiveness of resource use while minimizing the impact of that use on the environment.'

Research Promotion

Research Promotion is an annual fund-raising campaign conducted by the membership to raise funds for ASHRAE's research and professional education programs. Contributions are received from individual members as well as from companies associated with the HVAC&R industry. Since the fund-raising expenses are covered by the Society's budget, 100 percent of every dollar raised goes toward these programs.

ASHRAE Foundation

In 1994, a dedicated group of long-time ASHRAE members created ASHRAE Foundation to support the needs of the HVAC&R industry. ASHRAE Foundation is an endowed trust that provides funding for professional development and research programs, supplies qualified engineering students with much needed scholarship assistance, and ensures that ASHRAE will continue to have sufficient resources to sustain and expand the Society's vital work.

The creation of ASHRAE Foundation was in response to a valid need for increased funding for ASHRAE programs and projects. A solid proponent of education, the Foundation recognizes and accepts the challenge to provide the financial support necessary to offer tailored educational programming to ensure HVAC&R professionals are prepared today for tomorrow's challenges.

ASHRAExCHANGE

In 2013, the Society creates a discussion forum—ASHRAExCHANGE, for providing an online platform for real-time information exchange for design, construction, operation and support of the built environment. The value of ASHRAExCHANGE is collaboration and exchange of ideas with the other participants. This forum is open for both members and non-members for exchanging knowledge worldwide. Please visit <https://www.ashraexchange.org/> for details.

ASHRAE Standards and Guidelines

ASHRAE develops standards for both its members and others professionally concerned with refrigeration processes and the design and maintenance of indoor environments.

ASHRAE writes standards for the purpose of establishing consensus for:

- 1) Methods of test for use in commerce and
- 2) Performance criteria for use as facilitators with which to guide the industry

ASHRAE publishes the following three types of voluntary consensus standards:

- 1) Method of Measurement or Test
- 2) Standard Design and
- 3) Standard Practice

ASHRAE does not write rating standards unless a suitable rating standard will not otherwise be available.

Consensus standards are developed and published to define minimum values or acceptable performance, whereas other documents, such as design guides, may be developed and published to encourage enhanced performance.

ASHRAE is accredited by the American National Standards Institute (ANSI) and follows ANSI's requirements for due process and standards development.

ASHRAE Technical Committee

The technical expertise of ASHRAE is concentrated in its Technical Committees (TCs), Task Groups (TGs), Technical Resource Groups (TRGs) and Multidisciplinary Task Group (MTGs). These groups are responsible for:

- Preparing the text of ASHRAE Handbook chapters
- Originating, coordinating, and supervising Society-sponsored research projects
- Presenting programs at ASHRAE meetings
- Reviewing technical papers
- Evaluating the need for standards
- Advising the Society on all aspects of the technology it embraces

▶ ABOUT ASHRAE

More...(Cont'd)

ASHRAE Technical Committee (cont'd)

ASHRAE TCs consist of people who have a recognized proficiency in a specific field of interest. TGs, similar to TCs, are formed when a subject of current interest is not covered in the scope of an existing TC or when the subject encompasses the scope of more than one TC. TRGs are similar to TCs except that their responsibilities are limited to preparing, reviewing, or revising technical material. They do not have responsibility for programs, research, or standards. MTGs are different from TCs, TGs, and TRGs. The objective of the MTG is to first try and better coordinate and focus the activities of the affiliated TC and non-TC groups (EHC, REF, SSPCs, outside groups, etc) that make-up the MTG on the task for which the MTG was created without duplicating the functions of a TC or TG so that the task can be completed as efficiently as possible.

Young Engineers in ASHRAE (YEA)

To ensure the future of the Society and the industry, ASHRAE is committed to advancing its programs and services for young members through helping them build their professional foundations. With this in mind, ASHRAE created a committee called Young Engineers in ASHRAE (YEA), for members age 35 and younger. YEA can help you develop your skills, grow as a professional and expand your network, the YEA Institute was created to offer a variety of YEA focused education and networking programs tailored to your specific needs. Whether you're learning at a conference, attending a leadership weekend or receiving one-on-one advice from a fellow ASHRAE member, the YEA Institute is the perfect opportunity for you to make the most of your time with YEA.

ASHRAE Membership

Fellow

An ASHRAE Fellow is defined in the Society Bylaws as "A member who has attained distinction in the arts relating to the sciences of heating, refrigerating, air conditioning or ventilation, or the allied arts and sciences, or in teaching of major courses in said arts and sciences, or who by reason of invention, research, teaching, design, original work, or an engineering executive on projects of unusual or important scope, has made substantial contribution to said arts and sciences, and has been in good standing as a full grade Member for at least ten (10) years is eligible for election to the grade of Fellow by the Board of Directors."

An ASHRAE Fellow should be easily recognized as having attained distinction in the HVAC&R field, as detailed in the Society Bylaws. If such distinction is not sufficiently clear that it can be perceived simply by reviewing the candidate's biography and supporting documentation, either the candidate or his submittal is not ready for nomination to the grade of Fellow.

Life Member

ASHRAE members who have paid dues for over 30 years and have reached age 65 are automatically members of Life Members Club. No member of the Club is required to pay dues. The member shall retain all the rights and privileges of the most recent membership grade. The Club accomplishes its objectives by obtaining voluntary donations from members.

Member

Ideal For:

- Professionals with 12 or more years of experience in the industry
- Consulting & Design Engineers
- Architects
- Contractors

Member (cont'd)

- Code officials and other government representatives
- Facility engineers/managers
- Project/application engineers
- Technicians
Industrial/manufacturing engineers & management
- Public utility engineers
- Professors/instructors/researchers
- Sales engineers/manufacturers representatives
- Distributors/wholesalers

Qualifications:

The equivalent of 12 Society-approved years of experience composed of an approved combination of:

- Completed education beyond high school
- Work experience (including research, teaching, design, contracting, engineering sales, or engineering management)
- Professional engineering or related registration or license issued by a legally authorized body

Associate Member

Ideal for:

- Professionals with less than 12 years experience in the industry

Qualifications:

- Experience in technical matters or in design, operation, or maintenance in HVAC&R fields
- Interest in the advancement of the Society's aims, and sufficient qualifications to cooperate with HVAC&R engineers in the advancement of the knowledge relating to HVAC&R engineering and its application

Affiliate Member

Ideal for:

- New members who want an introduction to ASHRAE
- Younger professionals
- International professionals

Qualifications:

- Interest in the advancement of the Society's aims, and sufficient qualifications to cooperate with HVAC&R engineers in the advancement of the knowledge relating to HVAC&R engineering and its application
- For new members only. Must be under 30 years of age, and can only hold this grade for up to 3 cumulative years

Student Member

Ideal for:

Undergraduate and Graduate students in a:

- University
- College
- Junior college or
- Technical institute

Qualifications:

- Must be studying or have an interest in an HVAC&R industry-related field
- Matriculated in an approved course of study in the arts and sciences covered by the Society's objectives

About Region XIII

- History of Region XIII
- ASHRAE Region XIII 2013-2014 Regional Executive Committee
- Message from Mr. Vincent K C Tse
- Message from Mr. Raymond Y W Wong
- Message from Dr. C S Ow
- Message from Dr. Robert Y Z Hu
- Message from Mr. Wichai Laksanakorn
- Participation of Hong Kong Chapter
- Singapore Chapter
- Malaysia Chapter
- Taiwan Chapter
- Philippines Chapter
- Thailand Chapter
- Indonesia Chapter



History of Region XIII

Editor's Note: The history of Region XIII was prepared by the members of Region XIII with assistance from Joseph Ting, Ph.D., P.E., Region I.

The first meeting to discuss organizing Region XIII was held in May 1994, when a group of ASHRAE members from the Far East countries' chapters and Joseph Ting, Region I DRC, met at the Region X CRC.

It was at this conference that the Far East members realized their strong desires to form a separate region to service the chapter members from Singapore, Hong Kong, Malaysia and Taiwan. An impromptu meeting was held among the following: president Wong Wai Kwong and president-elect Roger Chu of the Hong Kong Chapter; president Steven Toh and president-elect K.S. Kannan of the Malaysia Chapter; president Ng Eng Hong, present-elect Leong Kai Choong and membership promotion chair Jeremy Chia of the Singapore Chapter; president Jimmy Wang and secretary Frank C.S. Jwo of the Taiwan Chapter and Region I DRC Joseph Ting.

This meeting set in motion the establishment of Region XIII. The evolution and growth of Region XIII took place at each successive Society meeting. At the Philadelphia meeting in January 1997, the leaders from Far East chapters reached a consensus and had a common understanding of the regional concept within the Society and prepared a motion to form a Far East region. At this informal gathering, all attendees felt that the time was right and that the Far East chapters were ready to form their own region in order to pay closer attention to their regional interests. It took a lot of iteration and re-iteration of the particular motion until everyone had come to a consensus. DRCs from Region I and

Region X provided invaluable advice to properly follow the Regions Council protocols.

Knowing that one of the prerequisites in forming a region required at least six chapters and 1800 members, everyone agreed that the motion should include a waiver to request an exception to one of the six requirements needed to form a region. It was early dawn when the task was finally completed.

Wong Wai Kwong was selected to represent the Far East members in presenting the motion at the International Committee meeting on January 27, 1997. Wong Wai Kwong delivered the motion to form Region XIII.

The motion was moved and passed with a majority vote at the Regions Council and was referred subsequently to the Council's Planning Committee. The Planning Committee, in turn, assigned the International Committee the action item to prepare all necessary documentation needed to petition the forming of a new region.

In the Spring of 1997, International Committee vice chair Ronald Kessner requested Ting to help draft the petition. Hong Kong Chapter was assigned to complete the petition including all necessary waivers. Philip Yu coordinated the completion of the petition. It was then circulated for review and signed by all officers of the four chapters and forwarded to the International Committee for further consideration.

On May 29, 1997, in Tempe, AZ, Kessner chaired the International Committee meeting. The motion to form Region XIII was presented and passed with an overwhelming majority. In June of 1997, the



10th Anniversary Celebration of the Region XIII

(From Left to Right)

- Mr. Jeff Littleton (ASHRAE executive Vice President 2007-08)
- Dr. Robert Y Z Hu (Director and Regional Chair 2007-2010)
- Mr. Kent Peterson (ASHRAE President, 2007-08)
- Dr. C S Ow (Director and Regional Chair 2004-07)
- Mr. Vincent K C Tse (Director and Regional Chair 1998-2001)
- Dr. Raymond Y W Wong (Director and Regional Chair 2001-04)

motion was voted on at the Planning Committee and recommended for approval by Regions Council at the 1997 Annual Meeting in Boston. At the Council's Sunday meeting, the motion was passed with a majority vote and at the Board's Wednesday meeting in Boston, the Board passed with a majority to have the Far East region formed and officially recognized as Region XIII at the Toronto Annual Meeting in June of 1998.

On August 14 & 15, 1998, Region XIII held its inaugural CRC at the Traders Hotel in Singapore under the auspices of Henry Lee, chair of the 1998 CRC.

▶ ABOUT REGION XIII

ASHRAE Region XIII 2013-2014 Regional Executive Committee

Position	Name	Chapter
Director and Regional Chairman (DRC)	Mr. Edward K C Tsui	Hong Kong
Assistant Regional Chairman (ARC)	Mr. Wichai Laksanakorn	Thailand
Region Members Council Representative (RMCR)	Mr. Jojo Dominador Castro	Philippines
Regional Vice Chair (RVC) for Membership Promotion	Mr. Bill Wei-Dong Wang	Taiwan
Regional Vice Chair (RVC) for Research Promotion	Mr. Cheng Wee Leong	Singapore
Regional Vice Chair (RVC) for Chapter Technology Transfer	Mr. Ching Loon Ong	Malaysia
Regional Vice Chair (RVC) for Student Activities	Dr. Sam C M Hui	Hong Kong
Regional Vice Chair (RVC) for Grassroots Government Activities	Mr. Yong Kong Ng	Malaysia
Nominating Committee Member	Mr. Sunny C L Tan	Singapore
Nominating Committee Alternative	Mr. David M H Lau	Singapore
Nominating Committee Reserve Alternative	–	–
Regional Historian/Conference Secretary	Mr. Den H G Low	Malaysia
Regional Refrigeration Chair	Mr. Apichit Lumlertpongpana	Thailand
Regional ECC (Electronic Communication) Chair/Webmaster	Mr. Vincent T W Chu	Hong Kong
Regional Treasurer	Ms. Chai Chi Hsu	Taiwan
Regional Representative (China)	Mr. Edward K C Tsui	Hong Kong
Regional YEA (Young Engineers ASHRAE)	Mr. Dennis L Alejandro	Philippines
Chapters Regional Conference (CRC) Chair 2013 (Indonesia)	Dr. Agus Wismakumara	Indonesia
Chapters Regional Conference (CRC) Chair 2014 (Taiwan)	Dr. Robert Y Z Hu	Taiwan
Chapter Delegate and Alternate:		
– Hong Kong	Ms. Tracy C M Pang Mr. Thomas H K Chan	Hong Kong
– Malaysia	Mr. Kim Seong Lam Mr. Say Jan Foo	Malaysia
– Indonesia	Mr. Totok Sulistiyanto Mr. Bugie Pudjotomo	Indonesia
– Philippines	Mr. Joselito B David Mr. Sherman Esmenda	Philippines
– Singapore	Dr. Uma Maheswaran Mr. Matthew Ngan	Singapore
– Taiwan	Dr. Yu-Hao Kang Mr. Hung Yao Chao	Taiwan
– Thailand	Mr. Chartchai Pisuttiboriboon Mr. Chakrapan Pawangkarat	Thailand

ABOUT REGION XIII ◀



Message from
Mr. Vincent K C Tse
Director & Regional Chair of
Regional XIII (1998-2001)

It is an honor and privilege to contribute this congratulatory message to the ASHRAE Hong Kong Chapter. This is truly a major achievement and one that we are all very proud of.

For 30 years the Hong Kong Chapter has literally gone from strength to strength and now maintains the position as one of the largest Chapter in the Society. We thank and salute the current and all the Past Presidents and their Committee members for their hard work, leadership, guidance and unselfish commitment to serving ASHRAE and the wider community over the past 30 years.

We would also like to thank the organizing committee for their great work in preparing this 30th Anniversary Memorial Booklet and I take this opportunity to wish the Hong Kong Chapter every success in their future endeavors.

Vincent Tse
DRC Region XIII (1998-2001)



Message from
Mr. Raymond Y W Wong
Director & Regional Chair of
Regional XIII (2001-2004)

It is my greatest pleasure to congratulate the ASHRAE Hong Kong Chapter on the occasion of their 30th Anniversary Celebrations. This is indeed a significant milestone in the development of the chapter and one that we are all very proud of.

The Hong Kong Chapter is one of the earliest ASHRAE chapter chartered outside the North American continent. It is one of the founding chapters of Region XIII and has the largest membership. Due in large part to the unselfish leadership, commitment and hard work from the past and present Chapter leaders and Committees in the service of ASHRAE and the larger community the Chapter has grown from strength to strength.

Finally, let us recognise the contribution of the Organizing Committee for the 30th Anniversary Celebrations and the Editorial Committee for the preparation of this Anniversary Booklet.

I wish the Hong Kong Chapter every success in their future endeavours.

Raymond Wong
DRC Region XIII (2001-2004)

▶ ABOUT REGION XIII



Message from
Dr. C S Ow
Director & Regional Chair of
Regional XIII (2004-2007)

I would like to congratulate the Hong Kong Chapter at this 30th anniversary celebrations and recognise its present leadership headed by Tracy Pang in enhancing issues on sustainability. Less we forget, may I be permitted to congratulate past leaders for their inaugural contributions to the formation of ASHRAE Region XIII. Being one of 4 chapters most active in its call for RXIII formation, one must not forget those key persons involved namely Phillip Yu, Wong Wai Kong and the first DRC Vincent Tse. Of course looking ahead, I believe the Hong Kong Chapter should be well positioned to reinvent itself in assisting the mainland CAR-ASHRAE GROUPs to mature and contribute towards ASHRAE'S broader visions. Once again in the year of the Horse, have a great nostalgic evening as you all have earned it through the 30 years of existence.

Datuk Ow Chee Sheng
DRC Region XIII (2004-2007)



Message from
Dr. Robert Y Z Hu
Director & Regional Chair of
Regional XIII (2007-2010)

It is my great honor to be invited to deliver a message for the Hong Kong Chapter 30th Anniversary. First of all, I would like to say "Congratulation" to Hong Kong Chapter for this special event. Members all around the globe come to Hong Kong on this special day to celebrate the great milestone that Hong Kong Chapter has achieved.

Hong Kong Chapter was founded in 1984 and is one of the largest Chapters in ASHRAE. Hong Kong Chapter is also one of the oldest chapters among Region XIII. As we can see in the past years, Hong Kong Chapter has made great contributions to not only the region but also to the society. Under the leadership of current DRC Edward Tsui from Hong Kong, I think Hong Kong Chapter will continuous maintain close and harmonious relationship with other professional institutions, also will continuously contribute great performance to our region.

From bottom of my heart, Congratulations to all of you in Hong Kong.

Robert Yie-Zu Hu
DRC Region XIII (2007-2010)



Message from
Mr. Wichai Laksanakorn
Director & Regional Chair of
Region XIII (2010-2013)

Thank you for the honor given to me for the privilege to contribute some words to Hong Kong Chapter.

With 30th Anniversary, ASHRAE Hong Kong Chapter has long been established and turn out to be one of the most successful chapter in our region. With the much higher number of members, among chapters in the region, HK Chapter have demonstrated that excellent activities has been carried out in term of convincing the engineers in the industry to see and acknowledge the benefit of being a member of ASHRAE. This is a great achievement.

During my tenure of service as Region XIII DRC, Hong Kong Chapter had demonstrated her maturity on running the ASHRAE Chapter to the full satisfaction of her members.

From what I know of all my colleague and friend in HK Chapter, I have my full confidence that HK Chapter will be able to maintain her status for many future years.

Wichai Laksanakorn
DRC Region XIII (2010-13)

▶ ABOUT REGION XIII

Participation of Hong Kong Chapter

The Region XIII was inaugurated in 1988. Hong Kong Chapter has been actively involving in the formation and development of the Region. Since then, members of the Hong Kong Chapter move up to participation in Society level operation. Hong Kong members serving the Society and the Region XIII include the following:–

Society Involvement:

Vice President	Mr. Vincent K C Tse (2007-2009)
Board of Directors	Mr. Vincent K C Tse (1998-2001) Mr. Edward K C Tsui (2013-2016)
Electronic Communication Committee	Dr. Roger C Y Chu (2004-2007)

Regional Involvement:

Director and Regional Chair	Mr. Vincent K C Tse (1998-2001) Mr. Edward K C Tsui (2013-2016)
Assistant Regional Chair	Mr. W K Wong (1998-2001)
Regional Vice Chair (Chapter Program)	Dr. Philip C H Yu (1998-2001) Dr. Roger C Y Chu (2001-2004)
Regional Vice Chair (Chapter Technology Transfer)	Mr. Alan Y W Lam (2004-2007) Dr. Raymond M H Yau (2007-2010)
Regional Vice Chair (Research Promotion)	Mr. Edward K C Tsui (2010-2013)
Regional Vice Chair (Student Activities)	Dr. Sam C M Hui (2011-2014)
Regional Nominating Member	Mr. W K Pau (2003-2005) Mr. Edward K C Tsui (2008-2010)



ABOUT REGION XIII ◀

Regional Webmaster	Dr. Sam C M Hui (1998-2011) Mr. Vincent T W Chu (2013-2016)
Regional Chair (Electronic Communication)	Mr. Vincent T W Chu (2013-2016)
Regional Nominating Reserve Alternate	Mr. Edward K C Tsui (2005-2007) Dr. K L Chan (2010-2012)
Meeting Secretary/Newsletter Editor	Mr. T K Chan (1998-2001)
Regional Representative (China)	Mr. Edward K C Tsui (2012-2014)
Chapters Regional Conference Chair	Dr. Roger C Y Chu (1999) Dr. Philip C H Yu (2005) Mr. W K Pau (2011)
Asia Pacific Conference on Built Environment Chair	Mr. Vincent K C Tse (2003)

▶ ABOUT REGION XIII

Singapore Chapter

On behalf of ASHRAE Singapore Chapter and our members, I extend my best wishes and congratulations to the Hong Kong Chapter for their 30th Anniversary.

It is indeed a great success and milestone for any society to achieve 30th Anniversary. Hong Kong Chapter has a very strong and cohesive team, with the most number of members in this region. They have been constantly putting good efforts to promote Heating, Ventilation and Air Conditioning (HVAC) around this region by organizing technical events, trainings and publishing technical book. They set a good example for us to follow.

With our long term good relationship, we look forward to work with Hong Kong Chapter to promote and contribute to the HVAC industry in this region. Last but not the least, we would like to take this opportunity to wish Hong Kong Chapter all the success and with another 40th, 50th, 60th ... Anniversary to come.

Best Wishes,

Matthew Ngan
President Elect (2013-2014)
Singapore Chapter



CRC in Hong Kong



Our 31st Installation Dinner and the whole team congratulate Hong Kong Chapter for their 30th Anniversary



Malaysia Chapter

Congratulations to ASHRAE Hong Kong Chapter on the celebration of your 30th anniversary.

I applaud the efforts of your members in the promotion and development of the HVAC industry in Hong Kong since your inception 30 years ago. I am confident your contributions for the benefit of the industry will not go unnoticed and will be well recognized and widely acknowledged.

We look forward to the continuing excellent collaboration between the chapters in this region to enhance the built environment.

On behalf of Malaysia Chapter, I wish ASHRAE Hong Kong Chapter all the best and every success into the future.



Lam Kim Seong
President (2013-2014)
Malaysia Chapter



ABOUT REGION XIII

Taiwan Chapter

Dear Hong Kong Chapter Officers & Members,

On behalf of ASHRAE Taiwan Chapter, I extend my warmest congratulations to your 30th Anniversary.

Hong Kong Chapter plays an important role in the advance and development of ASHRAE Region XIII.

We really appreciated the contribution and hard work of Hong Kong Chapter members for Region XIII.

You also have done a lot in promoting and advancing the technologies in the HVAC& R industry.

To all your efforts and achievements, I would like to take this chance to salute you.

I wish Hong Kong Chapter every success in its future endeavours.

Yours Sincerely,

Derek Kang
President (2013-2014)
Taiwan Chapter



Welcome reception of 2013 Region XIII 2nd RPM in Kaohsiung



Philippines Chapter



Dear Colleagues,

In behalf of ASHRAE Phil. Chapter I would like to congratulate ASHRAE Hongkong Chapter in celebrating its 30th Anniversary.

The Development of the officers has paralleled the vibrant growth of Hongkong Chapter especially the various activities and its dominated projects handled by them. We have over the years witnessed growth and success in the HVAC industry and promote a sustainable growth.

I certainly believe that ASHRAE Hongkong Chapter will bear fruitful results and lay firm groundwork for future development of ASHRAE in Region 13.

My best wishes and Happy Anniversary to all of you.

Sincerely yours,

Joselito B. David
President (2013-2014)
Philippines Chapter



▶ ABOUT REGION XIII

Thailand Chapter



Congratulatory Message for 30th Anniversary of Hong Kong Chapter from ASHRAE Thailand Chapter President

On behalf of ASHRAE Thailand Chapter, I would like to extend our best wishes and congratulations to ASHRAE Hong Kong Chapter on your 30th anniversary of service to the HVAC & R industry. Throughout the years I have enjoyed to know your dedication, enthusiasm and hard work for your activity to improve not only your chapter but also other chapters in this Region XIII.

ASHRAE Thailand Chapter is now moving on to its 14 years of service. We will be taking time to look back upon our first decade to reminisce on how our chapter became what it is today. In addition, we will look forward toward the next 10 years of our Chapter; developing our vision of where the chapter will be and what impact it will have on our community and industry in the future.



Again, your chapter's 30 years of service is truly a major achievement and I wish your chapter all success in this special occasion.

Chartchai Pisuttiboriboon

Chartchai Pisuttiboriboon
President (2013-2014)
Thailand Chapter

Indonesia Chapter

Congratulations to ASHRAE Hong Kong Chapter on 30 years of success. We have had the pleasure of cooperation and have found the management and organizing the chapter to be first rate. We would like to thank everyone at HK Chapter for going above and beyond the typical support and your willingness to do whatever it takes to satisfy the society."

how far you can save this blue

Happy Anniversary 30th ASHRAE HK Chapter



About Hong Kong Chapter

- History of Hong Kong Chapter
- Milestone of ASHRAE Hong Kong Chapter
- The Chapter's Organization
- Officers, Governors and Working Committees (2013-2014)
- List of Fellow and Life Members
- List of Honors and Awards of Hong Kong Chapter
- Student Branches

History of Hong Kong Chapter

Introduction

ASHRAE Hong Kong Chapter was founded in year 1984, initiated by several ASHRAE members among the leaders of the HVAC&R industry in Hong Kong who had the vision, the enthusiasm, and the great minds of serving.

Official Formation

The Charter of the Hong Kong Chapter was presented to Late Dr. Edwin H C Tao, its first Chapter President, at the Annual Meeting of ASHRAE held at Kansas City, USA, on Monday, June 18 1984. One week later, on June 25, 1984, formal certification for approval of its formation was officiated its legal existence in Hong Kong.

The Chapter had been granted a status of “Chapter-At-Large” for the first three years since 1984. In Society year 1987-88, the chapter was then assigned to Region X. After the ASHRAE Far East Conference that taken place in Hong Kong in the year 1992, the idea of forming a new Region for the Far East chapters was announced.

Further on days to days extremely great efforts of the Chapter members accompanied with the continuous encouragement from the DRCs of other Regions. Region XIII, the first Region of ASHRAE outside North America, was officially formed on July 1, 1998. Hong Kong Chapter, together with Singapore, Malaysia, and Taiwan Chapters, being its founding chapters, naturally became a member of that Region at the same time. Mr. Vincent Tse, a Past President of Hong Kong Chapter, was elected to be its first Director and Regional Chair (DRC).

The Philippines Chapter and Thailand Chapter joined in Region XIII in years 1999 & 2000 and followed by Indonesia Chapter in years 2007 & 2008 to share the friendship and support among other Chapters in this Region.

The process and ways of how it eventually evolved into the present Region XIII is recorded in the Region’s History of Region XIII.

Founding Board of Governors of ASHRAE HK Chapter

President:

Late Dr. Edwin H C Tao

Vice President:

Late Dr. Samuel P W Wong

Secretary:

Mr. Bryce Hunter

Treasurer:

Mr. Terry Berrecloth

Committee Chairs:

Mr. James Wu

Mr. Philip Chien

Late Mr. C O Synn

Mr. Alan Thompsom

▶ ABOUT HONG KONG CHAPTER

History of Hong Kong Chapter (Cont'd)

Chapter Presidents

Name	Society Year
(The late) Dr. Edwin H C Tao	1984-1985
(The late) Dr. Samuel P W Wong	1985-1986
Mr. Terry Berrecloth	1986-1987
Mr. Bryce Hunter	1987-1988
(The late) Mr. C O Synn	1988-1989
Mr. Alan Thompson	1989-1990
Mr. Vincent K C Tse	1990-1991
Mr. Rick Kroos	1991-1992
Dr. Daniel W T Chan	1992-1993
Mr. W K Wong	1993-1994
Dr. Roger C Y Chu	1994-1995
Mr. Francis Pang	1995-1996
Dr. Philip C H Yu	1996-1997
Mr. W K Pau	1997-1998
Mr. Alan Y W Lam	1998-1999

Name	Society Year
Dr. T T Chow	1999-2000
Mr. Edward K C Tsui	2000-2001
Mr. Victor Y M Yiu	2001-2002
Dr. Raymond M H Yau	2002-2003
Mr. Vincent T W Chu	2003-2004
Mr. Tim T Cheng	2004-2005
Mr. T K Chan	2005-2006
Dr. Sam C M Hui	2006-2007
Mr. S L Li	2007-2008
Dr. Raymond K L Chan	2008-2009
Mr. Calvin C H Tang	2009-2010
Ms. Eagle C Y Mo	2010-2011
Mr. Albert W F Lin	2011-2012
Mr. Albert C K Lo	2012-2013
Ms. Tracy C M Pang	2013-2014



ABOUT HONG KONG CHAPTER

Past Presidents Council

Supported by late Dr. Edwin H C TAO, a motion was moved by Mr. Edward K C Tsui in 2002 to form the Past President Council to provide counseling to the Chapter Officers and a closer link with the past presidents for a better succession and sustainability of the Chapter. The motioned was passed, and late Mr. C O Synn was nominated as the Chairman of the Council and Mr. Edward K C Tsui was nominated as the coordinator.

The Student Branch

Mr. Michael M K Chan, committee member 92/93 and 93/94, firstly inspired the students of Building Services Department of Hong Kong Polytechnic with enthusiasm for the formation of the First Student Branch in Hong Kong Chapter in 1994/95.

Now, we have five Student Branches in The Hong Kong Polytechnic University, City University of Hong Kong, Hong Kong Institute of Vocational Education, The University of Hong Kong, and Hong Kong University of Science and Technology.

Macau Section

With more and more development in Macau, members working and living in Macau has been increasing. In 2009, the Chapter saw a need to providing service to members in Macau and promoting ASHRAE in Macau. A section was formed in Macau. Technical events and liaison with concerned Authority are regularly organized.

▶ ABOUT HONG KONG CHAPTER

Milestone of ASHRAE HK Chapter

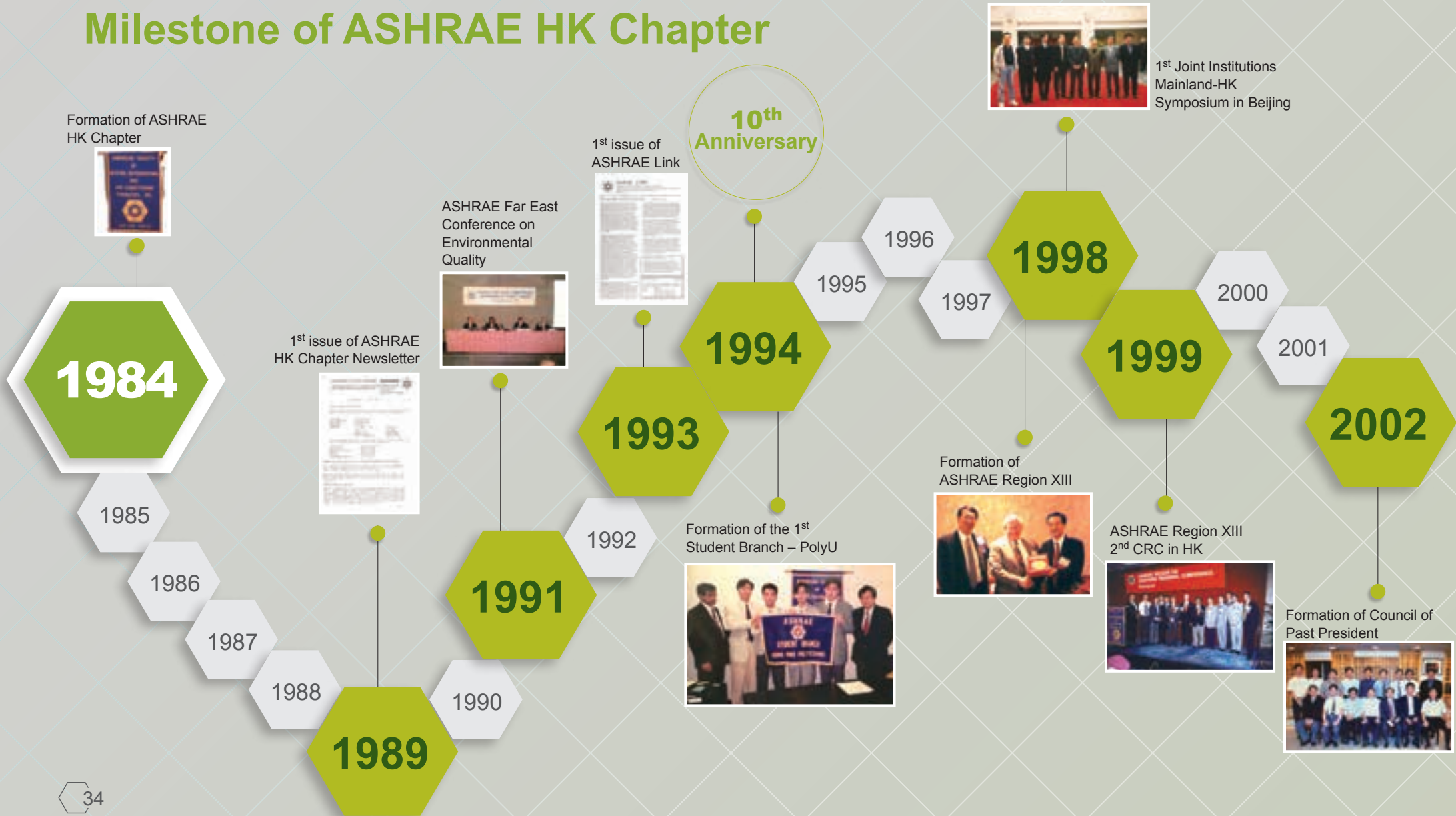

ABOUT HONG KONG CHAPTER



Formation of YMC

Forum on
"Mapping
out Atypical
Pneumonia"



20th
Anniversary

2003

Formation of
Technical Working
Groups

2004

1st APCBE in HK



HK Chapter 20th
Anniversary Dinner

2005

ASHRAE Regron XIII
8th CRC in HK



2006

2008



1st Joint Student Branch
AGM

2009

1st ASHRAE RP Walk



2010

"COOL HK" Book Launching



Silver Jubilee Dinner



Formation of
Macau Section



2011

ASHRAE Regron XIII
14th CRC in HK



2012

1st Issue of
Environmental
Friendly Newsletter



2013

2014

30th Anniversary of
ASHRAE HK Chapter



30th
Anniversary

▶ ABOUT HONG KONG CHAPTER

The Chapter's Organization

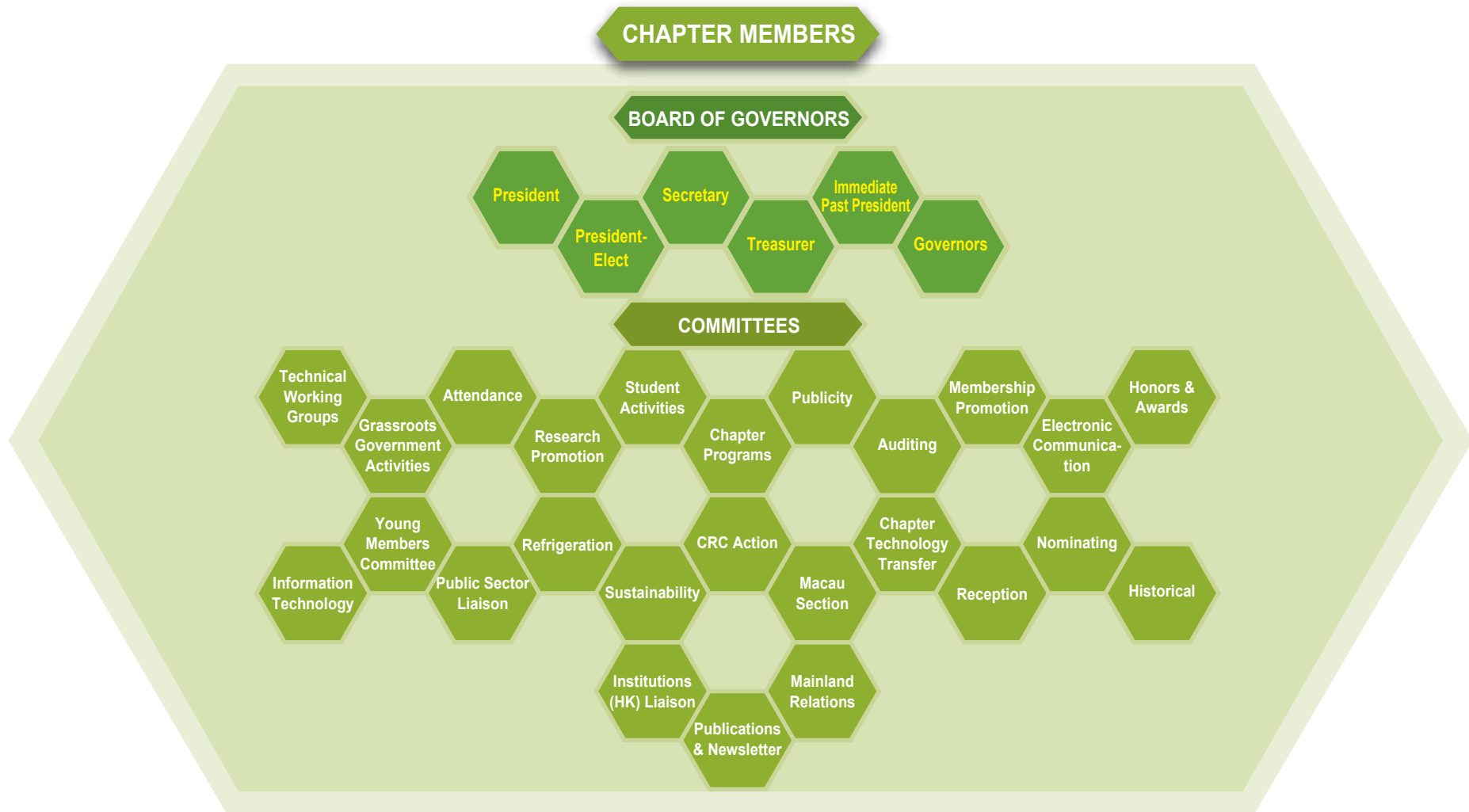

ABOUT HONG KONG CHAPTER ◀

Officers, Governors and Working Committees (2013-2014)

▶ Board of Governors



The Board of Governors is presented in two rows. Each member's name and title are displayed in a green arrow-shaped box pointing to the right, with a hexagonal photo of the member to its left.

President Ms. Tracy C M Pang	President-Elect Mr. Thomas H K Chan	Secretary Dr. C S Wong	Treasurer Dr. Dennis S L Tung	Immediate Past President Mr. Albert C K Lo
Governor Mr. Vincent T W Chu	Governor Dr. Sam C M Hui	Governor Mr. S L Li	Governor Mr. Vincent K C Tse	

▶ Working Committees

Chapter Technology Transfer



Members of the Chapter Technology Transfer committee are shown in a row. Each member's name and role are in a green arrow-shaped box pointing right, with a hexagonal photo to the left.

Mr. Cecil C H Man (Chair)	Dr. Albert T P So (Co-chair)	Dr. S L Wong (Co-chair)
-------------------------------------	--	-----------------------------------

Membership Promotion



Members of the Membership Promotion committee are shown in a row. Each member's name and role are in a green arrow-shaped box pointing right, with a hexagonal photo to the left.

Mr. Michael K L Sung (Chair)	Mr. Taylor C F Chow (Co-chair)
--	--

Research Promotion



Members of the Research Promotion committee are shown in a row. Each member's name and role are in a green arrow-shaped box pointing right, with a hexagonal photo to the left.

Mr. Tenny T L Tam (Chair)	Mr. Joao M C Wong (Co-chair)
-------------------------------------	--

▶ ABOUT HONG KONG CHAPTER

Officers, Governors and Working Committees (2013-2014)

▶ Working Committees

Student Activities



Mr. Patrick H M Huang
(Chair)



Mr. Jacky C K Ng
(Co-chair)



Mr. Wallace Yip
(Co-chair)

Attendance



Mr. Joe W H Chow
(Chair)

Auditing (2012-2013)



Mr. T K Chan



Mr. Calvin C H Tang

Chapter Programs



Mr. Peter Y H Lam
(Chair)



Ms. Sabina K Y Chung
(Co-chair)

CRC Action



Mr. Albert C K Lo
(Chair)

Electronic Communication



Mr. Kenny Y C Lee
(Chair)

Grassroots Government Activities



Dr. Raymond M H Yau
(Chair)

Historical



Dr. Roger C Y Chu
(Chair)



Mr. Tim T Cheng
(Co-chair)

ABOUT HONG KONG CHAPTER ◀

▶ Working Committees

Honors & Awards



Dr. Philip C H Yu
(Chair)

Information Technology



Mr. Alan Y W Lam
(Chair & Webmaster)

Institutions (HK) Liaison



Mr. Albert W F Lin
(Chair)

Mainland Relations



Mr. S H Wong
(Chair)

Nominating



Mr. Vicki W K Poon
(Chair)



Mr. Vincent T W Chu



Mr. Cecil C H Man



Mr. Jacky C K Ng

Publications & Newsletter



Mr. Carman K M Au
(Chair)

Publicity



Ms. Eagle C Y Mo
(Chair)

▶ ABOUT HONG KONG CHAPTER

Officers, Governors and Working Committees (2013-2014)

▶ Working Committees

Reception



Ms. Iris S W Li
(Chair)

Refrigeration



Mr. Jacky C K Ng
(Chair)

Sustainability



Mr. Alvin T Y Lo
(Chair)

Young Members Committee



Ms. Moka S Y Lai
(Chair)

▶ Technical Working Groups

Energy



Prof. S W Wang
(Leader)

Ventilation & Health



Dr. Apple L S Chan
(Leader)

Operation & Maintenance



Dr. Joseph H K Lai
(Leader)

Humidity



Prof. J L Niu
(Leader)

▶ Macau Section

Macau Section



Mr. Rocks S C Li
(Chair)



Mr. Tim T Cheng
(Co-chair)



Dr. Jacob C M Yiu
(Co-chair)

ABOUT HONG KONG CHAPTER ◀

▶ Student Branches

The Hong Kong Polytechnic University



Mr. Isaac Lo
(President)



Dr. M Y Chan
(Advisor)

City University of Hong Kong



Ms. Ning Wong
(President)



Dr. Square K F Fong
(Advisor)

The University of Hong Kong



Ms. Ryu Sin
(President)



Dr. Sam C M Hui
(Advisor)

Hong Kong Institute of Vocational Education



Ms. Crystal Chan
(President)



Mr. Y N Au Yeung
(Advisor)

The Hong Kong University of Science & Technology



Mr. Brian Yip
(President)



Prof. Moses Ng
(Advisor)

▶ ABOUT HONG KONG CHAPTER

List of Fellow and Life Members

Name	Grade
(The late) Dr. Edwin Tao	Fellow
(The late) Mr. C O Synn	Fellow
Dr. Tin Tai Chow	Fellow
Dr. Roger C Y Chu	Fellow
Mr. Vincent K C Tse	Fellow
Prof. Yuguo Li	Fellow
Prof. Jianlei Niu	Fellow
Mr. Ping Ki Kwok	Life
Mr. Ming Kong Chan	Life
Mr. Yue San Cheung	Life
Mr. David W K Chiu	Life
Mr. David K L Chiu	Life
Mr. Chake Ling Choy	Life
Mr. Woon Yuen Fung	Life

Name	Grade
Dr. George H C Hung	Life
Mr. Dennis H F Ip	Life
Mr. Hon Ming Lam	Life
Mr. Yiu Ming Lam	Life
Mr. John Lim	Life
Mr. John K Lo	Life
Mr. Shing Joe Lo	Life
Mr. Yuen Boon Lui	Life
Mr. Tin Shu Lai	Life
Mr. Kar Chuen Tam	Life
Mr. Chan S Tung	Life
Mr. Yam Wah Wang	Life
Mr. Mo Cheung Mo	Life
Mr. Hon Yue Woo	Life

List of Honors and Awards of Hong Kong Chapter

Hong Kong Chapter members have received the following Society-level Awards:

Fellow Member Award	Mr. Vincent K C Tse (1995) Dr. Roger C Y Chu (2003) Prof. Yuguo Li (2006) Dr. T T Chow (2008) Prof. Jianlei Niu (2013)
Distinguished Service Award	Mr. Vincent K C Tse (2003)
Regional Award of Merit	Mr. Vincent K C Tse (2000) Dr. Philip C H Yu (2001) Mr. W K Pau (2007) Dr. Roger C Y Chu (2008) Dr. Sam C M Hui (2008) Mr. Alan Y W Lam (2008) Dr. Raymond M H Yau (2010) Mr. Edward K C Tsui (2011)
Technology Award	Mr. Cary W H Chan (2006, 2013) Mr. W K Pau (2014) Prof. S W Wang (2014)

Chapter Service Award	Mr. C O Synn (2001) Dr. Roger C Y Chu (2004) Mr. Vincent K C Tse (2008) Dr. Philip C H Yu (2008) Mr. W K Pau (2008) Mr. Alan Y W Lam (2008) Mr. Edward K C Tsui (2008) Dr. Raymond M H Yau (2008) Dr. Sam C M Hui (2008) Mr. Victor Y M Yiu (2009) Mr. Vincent T W Chu (2009) Mr. Tim T Cheng (2009) Mr. S L Li (2011) Mr. T K Chan (2012) Dr. Raymond K L Chan (2012)
Ralph G Nevins Award	Prof. Christopher Chao (2005)
John F James International Award	Mr. Edward K C Tsui (2012)
Lou Flagg Historical Award	Dr. Philip C H Yu (2012)

▶ ABOUT HONG KONG CHAPTER

Student Branches

The Hong Kong Polytechnic University



The ASHRAE Student Branch at The Polytechnic University was established in 1994 about nine years after the HKPolyU BEng(Hons) Degree in Building Services Engineering was launched by the Department of Building Services Engineering in

1985 (4 years sandwich BEng. Students graduated in 1989). This year is the 20th student branch.

The understanding of the benefits of sustainability development and its implementation in the practice of building design is of importance for the long-term sustainability of Hong Kong. The Hong Kong Chapter has responded quickly to the changes in demand for sustainable design in building industry. In addition, the Chapter has successfully recruited many HKPolyU students in the past years to join the Chapter because the Chapter provides goods opportunities for student to participate in various function and activities related to HVAC&R. They can learn the knowledge of HVAC&R and other building technologies as well as making new friends. I wish all students will continue to participate in the activities of the Chapter and work together with the Chapter

to promote a sustainable design in buildings and building services.

Congratulate to the 30th Anniversary of the ASHRAE Hong Kong Chapter.

Best Wishes

Dr. M Y Chan

Student Branch Advisor
PolyU Student Branch

Student Branch Advisor

Dr. M Y Chan

(2011-present)

Prof. C M Mak

(2008-2010)

Dr. Daniel W T Chan

(2007-2008)

Student Branch Presidents:

2013/2014	Mr. Lo Yuk Shing, Issac
2012/2013	Mr. Chan Wai Kwan, Frapo
2011/2012	Mr. Lam Yiu Fat, Henry
2010/2011	Mr. Chow Chi Fung Taylor
2009/2010	Ms. Wong Yee Ting, Bonny
2008/2009	Ms. Lei Siu Man, Florence
2007/2008	Mr. Lo Siu On, Andy
2006/2007	Mr. Cheung Man Kwong, Jack
2005/2006	Mr. T T Lam, Michael
2004/2005	Mr. Ho Kwan Lok, Billy
2003/2004	Ms. Leung Sze Man
2002/2003	Ms. Ngai Man Kiu, Anna
2001/2002	Mr. Leung Siu Bang, Andy
2000/2001	Mr. Chiu Sin Hung, Raymond
1999/2000	Mr. Ho Wai Chung, Patrick
1998/1999	Ms. Cheung Fei Chui, Coco
1997/1998	Mr. Law Kwok Yin, Rocky
1996/1997	Mr. Yiu Chi Man, Jacob
1995/1996	Ms. Mo Cheung Ying
1994/1995	Mr. Chan Wai Leung

ABOUT HONG KONG CHAPTER

City University of Hong Kong



In celebrating the 30th anniversary of the ASHRAE Hong Kong Chapter, it is also grateful to be the 15th anniversary of CityU Student Branch of ASHRAE. I find a beautiful scene in the CityU Student Branch – the mutual

development of students from both associate and bachelor degrees. In these years, the associate degree graduates who are promoted to the CityU bachelor degree programmes would take up the leadership of the Student Branch, and they like to train up their junior schoolmates in associate degree on this platform. Even those associate degree graduates admitted by other local universities are also active in the related Student Branches. In the joint Annual General Meeting of the ASHRAE Student Branches, different generations of graduates gather around, like a valuable reunion of CityU alumnus. I cannot imagine such spreading effect happens when the CityU Student Branch was established fifteen years ago. These enthusiastic engineering graduates nourished from various Student Branches are being committed in the building services workplaces. With the passage of time, I sincerely wish their green and sustainable

mindset could penetrate into our community, leading to a change of human behaviour towards energy efficiency in buildings and beyond.

Dr. Square K F Fong
Student Branch Advisor
CityU Student Branch
(1999-present)

Student Branch Presidents:

2013/2014	Ms. Wong Lai Ning, Ning
2012/2013	Ms. Wong Tsz Yan, Margaret
2011/2012	Mr. Luk Wing Ping, Billy
2010/2011	Ms. Wong sze man, Mandi
2009/2010	Ms. Lai Sheung Yu, Moka
2008/2009	Ms. Ho Hong Ki
2007/2008	Mr. Vicky Lui
2006/2007	Mr. Henry Chan
2005/2006	Ms. Candy Fung
2004/2005	Mr. Ryan Chan
2003/2004	Ms. Tracy Pang
2002/2003	Mr. Au Siu Ki, Maxwell
2001/2002	Ms. See Mei King, Camby
2000/2001	Mr. Ma Ka Wai, Steve
1999/2000	Mr. Cheung Chi Pok

▶ ABOUT HONG KONG CHAPTER

Student Branches

The University of Hong Kong



ASHRAE HKU Student Branch
<http://me.hku.hk/bse/ASHRAE-HKU-SB/>

The ASHRAE Student Branch at The University of Hong Kong (HKU) was established in 2002. Prof. Yuguo Li was the Student Branch Advisor in 2002-2008 and has fostered the development of the Student Branch. A list of the committee members in the first year (2002/2003) is given below.

Chairperson:	Mr. Hugh Leung
Vice-Chairperson:	Mr. Jimmy Yam
General Secretary:	Ms. Allison Law
Financial Secretary:	Mr. Brain Chan
Promotion Secretary:	Mr. Francis Lam
Publishing Secretary:	Mr. Simon Chan

The Student Branch enables our students to participate in ASHRAE functions and learn the knowledge of HVAC&R and other building technologies. Through technical visits, overseas study tours, social events, career talks and interactions with the Hong Kong Chapter and other Student Branches, our students have gained valuable experience and friendship. This not only enhances their technical knowledge, but also provides good opportunities to develop their skills in leadership, teamworking, organisation, communication, people networking and problem solving. We are very grateful to the ASHRAE Hong Kong Chapter for continuing support and kind attention to the HKU Student Branch.

Dr. Sam C M Hui
 Student Branch Advisor
 HKU Student Branch

Student Branch Presidents:

2013/2014	Ms. Sin Kit Yan Ryu
2012/2013	Ms. Law Ting Fung Michelle
2011/2012	Ms. Kwan Sin Ki Irene
2010/2011	Ms. Ho Sze Wing
2009/2010	Ms. Li Shuk Wan Iris
2008/2009	Mr. Wong Man Chi Joao
2007/2008	Mr. Chow Chiu Fai Kevin
2006/2007	Mr. Yiu Chung Wai Eddie
2005/2006	Mr. Tam Ka Ngai Titus
2004/2005	Ms. Ho Yuen Shan Anita
2003/2004	Mr. But Hoo Hay Howard
2002/2003	Mr. Hugh Leung

Student Branch Advisors:

Dr. Sam C M Hui	(2008-present)
Prof. Yuguo Li	(2002-2008)

ABOUT HONG KONG CHAPTER

Hong Kong Institute of Vocational Education



It appears to me that I wrote for the 25th Anniversary of the ASHRAE Hong Kong Chapter just a short time ago. Now, it comes to the 30th Anniversary.

The IVE Student Branch of ASHRAE has been operated for 12 years. I would express my sincere thanks to the Hong Kong Chapter in its continuous support to the student activities including for example scholarships, study tours, site visits and talks. Our students have been giving chances to acquire professional knowledge and to achieve personal development through participation in various activities. It is also my honour to be the Branch Advisor and be part of the family.

The 30th Anniversary marks another milestone of development of the Chapter in the HVACR field in Hong Kong. The Chapter has been growing and moving forward in the frontline with contributions in different pressing/hot issues such as environmental conservation and sustainability. The framework of student branch provides a good platform for students to advance together with the Chapter in the field.

I would make use of this opportunity to congratulate the Chapter on its 30th Anniversary and wish it success in the years ahead.

Mr. Y N Au-yeung
 Student Branch Advisor
 IVE Student Branch
 (2002-present)

Student Branch Presidents:

2013/2014	Ms. Chan Wing Ki Crystal
2012/2013	Mr. Go Ho Fai Harvey
2011/2012	Mr. Jim Chin Ho Jimmy
2010/2011	Ms. Ho Hiu Ka Natalie
2009/2010	Ms. Ting Chung Man
2008/2009	Ms. Ng Wing Chi
2007/2008	Mr. Leung Sze Chun (up to end of 2007) & Ms. NG Kwan Lan (starting from end of 2007)
2006/2007	Ms. Yuen Cheuk Yin, Janet
2005/2006	Mr. Yam Wai Ming Steve
2004/2005	Mr. Cheung Ho Wah
2003/2004	Ms. Tong Yuen Ling Eunice
2002/2003	Mr. Cheung Chun Man

▶ ABOUT HONG KONG CHAPTER

Student Branches

The Hong Kong University of Science and Technology



The ASHRAE Student Branch at The Hong Kong University of Science and Technology was established in 2005. The First cabinet was formed by Gimble Wong. This year, the HKUST student Branch president is Brian Yip.

Each year, our student branch has a year plan. The student committee follows the year plan to hold the functions that the Student Branch may help our students to participate in ASHRAE function. Those functions include site visits, charity functions, outdoor activities and also overseas activities. Our student branch committee always promotes the ASHRAE Hong Kong Chapter in HKUST in order to help HKUST students to familiarize with ASHRAE.

Congratulate 30th Anniversary of the ASHRAE Hong Kong Chapter.

Prof. Mosses L F Ng
Student Branch Advisor
HKUST Student Branch

Student Branch Advisor

Prof. Mosses L F NG (2010-present)
Prof. Christopher Chao (2005-2010)

Student Branch Presidents

2013/2014	Mr. Brian Yip
2012/2013	Mr. Carlos Chan
2011/2012	Mr. Lui Tsz Kin
2010/2011	Mr. Keith Siu
2009/2010	Mr. Billy So
2008/2009	Mr. Hugo Chan
2007/2008	Ms. Yolanda Lam
2006/2007	Mr. Alex Lam
2005/2006	Mr. Gimble Wong

ABOUT HONG KONG CHAPTER

Photo Album of Student Branches:



2009 Thailand Study Tour



2010 Singapore CRC Study Tour



2010 Student Branch Site Visit



2011 Joint Student Branch AGM



2012 Joint Student Branch AGM



2012 Malaysia Study Tour



2013 ASHRAE RP Walk



2013 Indonesia Study Tour



2013 Joint Student Branch HKJC Site Visit



2013 Joint Student Branch AGM CityU



2014 HKU student branch Holiday Inn Soho Site Visit



2014 HKU Student Branch ICC Site Visit

Past Presidents' Message

- | | | | |
|----------------------------|---------|----------------------------|---------|
| → 1. Mr. Alan C A Thompson | (89-90) | → 12. Dr. Raymond M H Yau | (02-03) |
| → 2. Mr. Vincent K C Tse | (90-91) | → 13. Mr. Vincent T W Chu | (03-04) |
| → 3. Dr. Daniel W T Chan | (92-93) | → 14. Mr. Tim T Cheng | (04-05) |
| → 4. Mr. W K Wong | (93-94) | → 15. Mr. T K Chan | (05-06) |
| → 5. Dr. Roger C Y Chu | (94-95) | → 16. Dr. Sam C M Hui | (06-07) |
| → 6. Dr. Philip C H Yu | (96-97) | → 17. Mr. S L Li | (07-08) |
| → 7. Mr. W K Pau | (97-98) | → 18. Dr. Raymond K L Chan | (08-09) |
| → 8. Mr. Alan Y W Lam | (98-99) | → 19. Mr. Calvin C H Tang | (09-10) |
| → 9. Dr. T T Chow | (99-00) | → 20. Ms. Eagle C Y Mo | (10-11) |
| → 10. Mr. Edward K C Tsui | (00-01) | → 21. Mr. Albert W F Lin | (11-12) |
| → 11. Mr. Victor Y M Yiu | (01-02) | → 22. Mr. Albert C K Lo | (12-13) |

PAST PRESIDENTS' MESSAGE ◀



Mr. Alan Thompson (89-90)

Dear HK Chapter members

After leaving Hong Kong in 1993 where I was Building Services Manager for Fletcher Construction, I returned to New Zealand and formed my own consultancy practice specialising in HVAC and hydraulic services. I am considering retiring later this year to do some travelling. I am now an ASHRAE Fellow life member. I wish the Hong Kong Chapter, which I helped to form, all the very best for the future

Kind regards
 Alan Thompson
 Past Chapter president



Mr. Vincent K C Tse (90-91)

Achievement as a member of ASHRAE

ASHRAE is a great global society of HVAC&R. ASHRAE HK Chapter provides a good training ground for young and enthusiastic engineer to serve the HK engineering society and our members. I was very fortunate to be elected as the first Director and Regional Chair for Region XIII in 1998. The formation of Region XIII provides us a platform to meet with all HVAC&R engineers in the Far East and also has given me an opportunity to serve all members as ASHRAE Vice President in 2007-2009 and other ASHRAE Board member up to today.

Advice to Young Members

Participation in ASHRAE HK Chapter activities, there is always one very important and fundamental reminder: "We will have more happiness in giving than in receiving."

To serve the chapter as a committee member is not to find way to promote or elevate yourself but to show how you can appreciate all other committee members and contribute your part the best for the Chapter and serve all members in HK.

Looking Forward

Congratulations to HK Chapter for her 30th anniversary. After 30 years, it is necessary for all of us to sit back and re-visit our chapter goals. Should our goals be focus on increasing members, technology development, social gathering again? Could we focus more on members caring, young member training and development, etc. Without care to our young people, we will have no hope in the future for further growth.

Best wishes to all people in ASHRAE HK.

PAST PRESIDENTS' MESSAGE



Dr. Daniel W T Chan (92-93)

It is my great pleasure to write a greeting for the 30th anniversary for ASHRAE Hong Kong Chapter. It has been twenty three years since I was the President of the Hong Kong Chapter. It is joyful to see the growth of the Chapter under the enthusiastic effort of an elite group in our BSE industry. I am also grateful to a group of young professionals to keep the Chapter Newspaper ASHRAE Link in publication since I started it in 1992. Three decades that it has elapsed, ASHRAE distinguishes from other professional institution in that the past presidents are still link to the Chapter, not to direct, but to enjoy the flourishing and growing impetus of the new generations. The Chapter is never short of feeders from the student chapters of the local academic institutions. I am predicting the establishment of a new Student Chapter from the Technological and Higher Education Institute (THEi) of the VTC in the near future.



Mr. W K Wong (93-94)

Over the years we share quite the same inspirations and aspirations about ASHRAE, so we merge our messages into one, like we did on the 25 year anniversary of the Chapter.

In the early parts of the nineties of the last century, before Region XIII was born, participating together in the CRC of Region X in California (as Chapter President and President Elect) opened our eyes and minds about what ASHRAE really is/ has beyond the four handbooks. Among many others, there is so much history, culture, knowledge, experience and experiencing, and people connection; we thought we should make this rich treasure reachable to more of our HVAC&R practitioners in Hong Kong.

To make it happen, we must first take our Chapter up to the next level, by guiding our chapter operation back to closely follow the Chapters Operation Manual, to enroll more new members as well as young members into our operations team, and to instill a transparent and fair “career map” within the Chapter that applies to members of any age group, financial or social background.

So there came about the formation of our first Student Branch (HKPolyU), crash learning of Robert's Rules of Order, Six Thinking Hats workshop, dedicated efforts towards PAOE, Membership Promotion and Research Promotion, etc. In subsequent years, our membership had once topped as number one in the Society, the position long clasped by New York Chapter – chapter number 1.

PAST PRESIDENTS' MESSAGE ◀



Dr. Roger C Y Chu (94-95)

Maturity of our chapter operation, as a result of the heartfelt work of everybody, was no doubt an important consideration of the Society for approving formation of Region XIII.

After years and years striving for growth and expansion, perhaps it would make sense to pause, and review some basics:

The chapter does not act for or on behalf of the Society. What happens if the chapter is requested by the local government or other parties for technical opinions? They are seeking information from and of the Society, through the Chapter; supplying any information other than referring them to those published by the Society, the chapters would be misleading the public. By the same token, the *Chapter does not act for or on behalf of their members; our role is to serve them.*

We would like to thank all anniversary celebration organizing committee and editorial committee continued commitment to this special event and we wish all of you happy and unforgettable evening.



Dr. Philip C H Yu (96-97)

Achievement as a member of ASHRAE

During presidency, the Hong Kong Chapter launched official website – primitive but a solid base to develop such inevitable tool today to serve the members and the community. It's also the critical time of Hong Kong's returning to Mainland. I took the initiative to start the dialog with the Mainland engineering society (e.g. WU Yuan-wei, FAN Cun-yang, LONG Wei-ding, etc.), which was subsequently developed into a regular Mainland-HK technical exchange seminar. Also, I'm glad to be involved in the formation of Region XIII.

Advice to Young Members

I'm proud of the Chapter's heritage that has been encouraging young members' participation, fair learning and advancing opportunity as well as investing in student branches. It has 20 years history indeed and I'm a good example – the first youngest president 😊

Looking Forward

While embarrassing young and dynamic side of the Chapter's heritage, let's not forget the basics... open to various challenges, respond to the societal needs, and make good use of what we have. With that, I'm looking forward a sustainable future!

PAST PRESIDENTS' MESSAGE



Mr. W K Pau (97-98)

I took up the President post of ASHRAE Hong Kong Chapter on 1st July 1997 which is also the first day Hong Kong becomes a Special Administrative Region of China. Following the closer collaboration between the Mainland China and Hong Kong, it is really my honour to be one of the Organizing Committee members represented the Chapter to organize the first Mainland – Hong Kong HVAC Seminar together with the HVAC Committee of China Association of Refrigeration (CAR), the CIBSE Hong Kong and the BS Division of HKIE. The event was held successfully in Beijing during 23 – 25 March 1998. I am glad to see that this event is now become the annual activity and the focus is expanding from HVAC to more aspects covering energy, green and many other topics related to sustainability.

It is so encouraging to see the development of the Chapter over the past decades in the society level, regional level and locally with the support from our friends, members and many volunteers. I sincere congratulate ASHRAE Hong Kong Chapter for its 30th Anniversary and look forward to seeing its continuous growth in the future.



Mr. Alan Y W Lam (98-99)

Achievement during the term of presidency

To make a closer link between the ASHRAE headquarters and the Hong Kong Chapter, I had involved in the formation of Region XIII during my terms of Secretary and Vice President since 1996. It was glad to have the successful formation of Region XIII in June, 1998. Regarding the membership development, there was around 5% increase of the membership in my term of presidency. The Hong Kong Chapter had also helped the successful development of the membership in Shanghai in the Mainland in 1998. At that time, there were more than fifty (50) members in Shanghai. It was good enough for the formation of the first Chapter in the Mainland.

Advice to Young Members

I would like to give a word of “LOVE” to our young engineer. “LOVE” is formed by four characters, i.e., L – stands for Life, O – stands for Opportunities, V – stands for Voice and E – stands for Ethic.

Our young engineer shall grasp the golden working Life in their career path and equipped themselves to be a professional engineer. There would be a lot of Opportunities for our young engineer to climb up their ladder. They should Voice out their needs or questions in their works for increase of their knowledge pool. Ethic is particularly important to a professional engineer.

Looking Forward

There is a niche for the further development of HVAC industry as per the statutory requirement of energy consumption of a commercial building in Hong Kong. Our knowledge of saving energy in the design and the operation of HVAC equipment is paramount in the coming future.

Congratulations on the 30th Anniversary of the ASHRAE Hong Kong Chapter.

PAST PRESIDENTS' MESSAGE ◀

**Dr. T T Chow (99-00)****Achievement as a member of ASHRAE**

I am proud to be an ASHRAE Fellow and observe the healthy developments in all these years. 15 years ago when I was the Chapter President stepping across the two centuries, it was enjoyable to have the CRC meeting first time held in Hong Kong, the second Student Branch formed, and the third Mainland-HK HVAC Seminar led by us.

Advice to Young Members

As an HVAC engineer in Hong Kong, the mind-set should never be limited to go for the most sophisticated technologies or to maximize the return on investment. The soul of this profession lies in striving balance between the life-long energy performance and the health and safety aspects. One needs to work closely with other professionals to come out with sustainable solutions via multi-disciplinary efforts.

Looking Forward

Facing the imminent global climate change, fossil fuel depletion and carbon emission issues, the ASHRAE international community is an excellent platform for the sharing of expertise from concrete experiences to new innovations. The Hong Kong Chapter has achieved so much in the past and it is my pleasure to see more deliberating efforts and breakthroughs.

**Mr. Edward K C Tsui (00-01)**

I would like to congratulate ASHRAE Hong Kong Chapter on her 30th Anniversary.

I am proud to be a member as well as past president of the Hong Kong Chapter. It's always a pleasure to work with other chapter members including student members from the five (5) student branches. The energy, enthusiasm, commitment from all volunteers is the leading exemplar of the chapter.

Over the past three decades, ASHRAE Hong Kong chapter has been contributory in building the reputation of engineering, delivering benefits to the members. Embracing the past and looking to the future, I believe the chapter and the members will continue their commitment in serving the humanity and promoting a sustainable built environment.

May I wish all the best for the future of ASHRAE Hong Kong chapter and for all the volunteers and leadership. Shaping the NEXT!

PAST PRESIDENTS' MESSAGE



Mr. Victor Y M Yiu (01-02)

Achievement during the term of presidency

To enhance the efficiency of our meetings, the Chapter conducted a workshop for the officers and committee members on the application of Roberts Rules of Order. These rules had been adopted for use in the BoG Meetings. The Chapter Byelaws were reviewed, amendments proposed and endorsed by the Chapter for formal submission to Society and which were subsequently approved by HQ. The 3rd and 4th Student Branches, formed by the student members of HKU and IVE respectively, were established and installed in 2002. A SWOT analysis was carried out in helping to formulate action plans for an improved "status" and operation of the Chapter. Guidelines for the Auditing Committee to follow were produced. A College of Presidency (Past Presidents Council) was set up for the purposes of providing guidance and assistance to and sharing of invaluable experience with incoming officers.

Advice to Young Members

To help increase and maintain competitiveness, young engineer must continuously sharpen themselves through their life-long career. I would expect they understand that "Knowledge is a Tool", "Attitude is the Way", and they should "Be Prepared" and practise the habit of "Begin with the End in Mind".

Looking Forward

Congratulation on the 30th Anniversary of the ASHRAE Hong Kong Chapter.

I hope the Macau Section will soon become a Chapter of the Region.



Dr. Raymond M H Yau (02-03)

Achievement as a member of ASHRAE

I joined the Hong Kong Chapter of ASHRAE in 1992 and began to serve the Chapter at the various committees as member or chair. I was elected as the Treasurer, Hon. Secretary and President-elect in 1999, 2000 and 2001 respectively. In 2002, I served as the President of Hong Kong Chapter. During my term as President, I led to set up the Young Members Committee to fulfill their needs and aspirations. Between 2007 and 2010, I served the ASHRAE Region XIII as Regional Vice-chair for Chapters Technology Transfer. In 2013, I serve as the Chair of the newly formed Grassroots Government Affairs Committee of the Chapter and continue to serve as voting member in the ASHRAE Technical Committee on Sustainability and Environment.

Advice to Members

ASHRAE is such a resourceful organisation that possesses indepth and specific technical knowledge for professionals and practitioners in creating a better built environment and combating climate changes. ASHRAE's technical publications or solutions are adopted or referred in our everyday's lives such as energy saving standards, green building design guides. BEAM Plus, the green building rating scheme in Hong Kong, also adopts ASHRAE standards as references in the assessment credits in energy saving, ventilation, indoor environment quality and lighting. An ASHRAE engineer should unrelentlessly equip ourselves with the resourceful knowledge and share it with the community and the future generation.

Recent Services to the Community

I am serving as directors of Hong Kong Green Building Council and BEAM Society Limited.

PAST PRESIDENTS' MESSAGE



Mr. Vincent T W Chu (03-04)

It was the time when Hong Kong was badly hit by the SARS when my term of presidency started. Fears and uncertainty filled the society. A photo was taken during our Board of Governors meeting with all participants wearing surgical masks, which marked this unforgettable time. Fortunately, with support from all members, the Chapter went through the year successfully.

It was a busy year of the Chapter. We were celebrating the Chapter's 20th Anniversary with a series of celebration activities, including a large scale celebration dinner, publishing a memorial booklet of the Chapter, etc. Besides, we also held the Asia Pacific Conference in Built Environment in Hong Kong. This provided a platform for chapters in the Region XIII to exchange latest research and technology development in built environment. Internally, we have strengthened the auditing mechanism to cope with the continual growth of the Chapter. External auditing by a certified public accountant was introduced. This increases the accountability of the Board and transparency of chapter operation.

I am happy to see the continual growth of the Chapter. Happy 30th Anniversary to Hong Kong Chapter!



Mr. Tim T Cheng (04-05)

Warmest congratulate on ASHRAE Hong Kong Chapter 30th anniversary in 2014.

ASHRAE vision, research achievements and Chapter local events benefit our members the advance of HVAC&R technology and widen their network. To maintain Hong Kong Chapter to be one of the large Chapters in ASHRAE, during my Presidency year, we arranged over 40 technical events including seminar, technical talk, visit and symposium and got enthusiastic responses. It reached out more people and increased the awareness of our members.

To strengthen the relationship with other Societies with promoting ASHRAE to increase membership, we invited many partnering Societies to arrange several Joint functions that received high participation and encouraging feedback. We also actively participated in Government on formulating and developing the related technical standards, guidelines and initiatives for Hong Kong, we have joined many advisory meetings and we were invited to seat in some regular advisory groups.

In order to provide better service for our members, we gathered all good practices and share with best experience to improve our Manual of Chapter Operation as a guideline for Chapter officers and committee reference.

PAST PRESIDENTS' MESSAGE



Mr. T K Chan (05-06)

It is my great honour to have the opportunity to serve ASHRAE Hong Kong Chapter as the President for 2005 to 2006. During my term of Presidency, the Chapters Regional Conference (CRC) was held in Hong Kong. It was the second CRC held in Hong Kong after the establishment of Region XIII in 1998. With full support at all levels of the Chapter, the CRC was a great success. After formal business, many CRC participants and their family members seized the chance to visit the newly opened Hong Kong Disneyland and had fun! The Chapter has also outreached to Macau and nearby China cities to explore opportunities for collaboration of learned society activities.

With fast changing technologies, many opportunities are available to our young engineers to learn the latest development in HVAC&R. However, the most valuable asset that I have got is the personal network established and the problem solving experiences gained during my services with Hong Kong Chapter.

For young and practicing engineers in the HVAC&R industry, I fully recommend ASHRAE to you as your lifetime organization for professional development and advancement.



Dr. Sam C M Hui (06-07)

I was encouraged by my beloved HVAC&R teacher Mr. S. K. Wang to join ASHRAE as a Student Member. Then I developed interest in ASHRAE and its activities throughout the years. I am very pleased to have served the ASHRAE Hong Kong Chapter as the President in 2006-2007. At that time, the Chapter has already established a tradition and people network that enabled us to make friends with each other and participate in various professional and social functions.

To allow our younger generation to develop themselves through ASHRAE, since 2006, I have helped to organize the student technical study tour during the Chapters Regional Conference (CRC) of ASHRAE Region XIII in each year. I hope that more young people can join ASHRAE and make use of the opportunity to expand their horizons.

I would like to express sincere thanks to the Chapter officers, Governors and Committee Members in 2006-2007. Without their strong support, I would not have achieved the tasks for the Chapter at that time. For example, we have invited the ASHRAE President Mr. Terry Townsend and President-Elect Mr. Kent Petersen to visit Hong Kong in 2006. We have also started the new initiatives on developing a publication on history of HVAC&R in Hong Kong as well as establishing the Sustainability Committee.

I believe the ASHRAE Hong Kong Chapter has provided an invaluable platform for people to develop knowledge, exchange ideas, and foster friendship. Through the local, regional and international activities of ASHRAE, we can have good networking and interesting experience for professional development.

PAST PRESIDENTS' MESSAGE ◀



Mr. S L Li (07-08)

Achievement as a member of ASHRAE

I feel proud of being one of the past presidents of ASHRAE Hong Kong Chapter. I was elected at the juncture and transition due to aging from the Chapter. With supports across all spectrums, we manage to accomplish all of our objectives and recapture the growth of the chapter by deploying quite a few initiations to recruit and promote new and junior committee members to fill up all vacancies within Hong Kong Chapter.

Advice to Young Members

Volunteerism is like a candle fire which passes on the light to help others without taking away anything from us. Instead, we together will kindle a brighter world to shine the road ahead in betterment of our technological and environmental development in living.

Looking Forward

Young generations will certainly become our engines to leap Hong Kong Chapter forward. I look forward to continuing to serve ASHRAE as well as engineering communities.



Dr. Raymond K L Chan (08-09)

Thinking about five years ago, I was honor to be the President and made humble contributions in publishing a book – COOL Hong Kong to document the development of HVAC&R in Hong Kong and also in memory of the Chapter's Silver Jubilee. In 2010, I was designated as the convener of committee for promotion, exhibition and distribution of the book. Over 800 copies were sold in two years.

As one of the members of Golf Team, we got the championship in golf tournament amongst HKIE BSD, CIBSE HKB and ASHRAE HKC in 3 consecutive years (2010-2013). The merit must go to our golf team leader – Mr. H.W. Yu and comrades – Mr. Ben L.Z. Liu, Mr. S.H. Wong and Mr. Andrew C.S. Cheung.

On the occasion of its 30th Anniversary, I would like to commend all professionals and people who have served the ASHRAE HKC. Their enthusiasm and passion to serve the industry are worth of learning by young generation. With the great foundation laid by them, I am confident that the HKC will continue to grow and contribute to the development of Hong Kong in the years to come.

PAST PRESIDENTS' MESSAGE



Mr. Calvin C H Tang (09-10)

Achievement as a member of ASHRAE

This my great of honour as past presidents of ASHRAE Hong Kong Chapter. We established Macau section to provide better networking support and communication platform to our members who working in Macau. ASHRAE Hong Kong chapter limited had been registered, the chapter can be operated under a limited company, which can improve our risk management and liability control. We also re-actuated one of our student branch in University of Science and Technology HK.

Advice to Young Members

I suggest that entry-level people adopt the entrepreneurial spirit to do whatever it takes to make the production successful for everyone, as a team member. All things being equal, the person with the better interpersonal skills will go further in their career."

Looking Forward

Hong Kong chapter will keep contribute in the communication and learning platform for green, sustainability, energy saving know- how, we will continue to develop students and young engineers, we are looking forward our next 30th anniversary of Hong Kong chapter.



Ms. Eagle C Y Mo (10-11)

Achievement as a member of ASHRAE

I joined ASHRAE as a student member in 1994 when I was a year 2 student studying Polytechnic University Building Services Department. In the same year, I joined the Poly U ASHRAE Student Branch as committee members which was just set up and was the first student branch in HK Chapter. Next year I was elected as President of ASHRAE Student Branch. Since then, I continue to serve HK Chapter and then elected as the Chairlady of the first year Young Member Committee (YMC) when it was just set up in 2003.

I continue to work in ASHRAE until I elected as ASHRAE President in Year 2010, at that time, I am the firsts Lady President in HK Chapter.

Advice to Young Members

I believe our young members could gain a lot through ASHRAE, as you would obtain much valuable experience from our senior ASHRAE professionals. Particularly, try to communicate with our fellow ASHRAE members from other countries, it would much broaden your vision and it's very helpful for your future career development.

Looking Forward

I sincerely hope more and more female engineers will participate in engineering or construction industrial. Therefore, in the coming years, I will to do some promotion in this aspect and encourage more and more youngers, particularly females to study engineering or construction related subjects no matter diplomas, degrees or masters, thus could supply fresh blood to the construction industry.

PAST PRESIDENTS' MESSAGE ◀



Mr. Albert W F Lin (11-12)

As an engineer, ASHRAE's mission to serve humanity and promote a sustainable world by advancing technology in built environment has inspired me the importance of serving others by our professional knowledge.

Promotion of ASHRAE Rebranding

The rebranding of ASHRAE was announced in January 2012. Along with the change of our Society logo, our Chapter website was revamped and enhanced in navigation and search engine in 2012.

Knowledge Exchange with Different Regions

Hong Kong Chapter has enhanced its role in knowledge exchange by holding regional conference and joint symposium with the Mainland cities. Our Chapter hosted the 14th CRC in Region XIII in August 2011, with over 300 local & overseas professionals participated in the Technical Seminar. Prominent speakers were invited to share the topic "High Performance Building Design".

Nurturing Young Engineers

ASHRAE has been active in outreaching student members through in different universities and colleges. By initiating the Oversea Study Tour, ASHRAE Hong Kong Chapter Student Scholarship, technical workshops and factory visits in 2011, our student members could have more opportunity to be trained and involved in the Chapter's activities.



Mr. Albert C K Lo (12-13)

It is amazing how fast the year goes by.... my term (2012-13) is no exception and before we know it ..., it will be our 30th Anniversary Annual Dinner.

During my term, I have joined many activities, including China Joint Symposium in Fujian, CRC in Malaysia, Student Branch Promotions, India Chapter Conference, Host for our Society VP, Tim Wentz & President-Elect, Bill Bahnfleth, DL talks including Dr. Jerry Yang, Dennis Knight, Roberto Aguilo, Om Taneja & Joseph Lai, Winter Meeting & 100th Anniversary for Trane in Dallas, RP Walk, RP Golf Day, Workshops with ACRA & Platinum, many Annual Dinners form other Societies & Institutions, etc. Besides, we have set up the sustainability committee in our Chapter and got the Technology Award, Honorable Mention for Swire Properties, Alwin B. Newton Scholarship for our Ms. M S Chan and the approval of Fellow Member for Dr. Jianlei Nui from the Society. Furthermore, we have set up a task force to implement our Society to the American Society of Heating, Refrigerating and Air-conditioning Engineers Hong Kong Chapter Limited for operating the ASHRAE Hong Kong Chapter effective on 1 July 2013. Meanwhile, we have collaborated with ACRA and Platinum to provide the workshops for our members, other society members, friends in the related industry.

Lastly, I would like to take this opportunity to congratulate our 30th Anniversary of the Chapter for next level.



ASHRAE Hong Kong Chapter Future Leaders



ASHRAE HONG KONG CHAPTER FUTURE LEADERS



Tracy Pang

Why did you join ASHRAE?

Billy So

UST SB President (09-10), YMC member (11-14)

I joined ASHRAE since 2009 and I was a student member at that time. Throughout three years student life, it had join lots of activities like site visit, technical talk and study tour. ASHRAE gave me lots of opportunities to learn and broaden my horizon. It is a great platform for me to know more about HVAC industry and enhance my networking in this field.



Ray Lam

PolyU SB committee (09-11), YMC member (11-13), YMC Co-chair (13-14)

I've joined ASHRAE when I am studying in Associate Degree. I was first told to know ASHRAE during the promotion What I expected in joining ASHRAE are not only to have more understanding and knowledge in building services especially HVAC system for my study and career development, but also to have more activities during my study period. Until now, the expectation was achieved.



Frapo Chan

CityU SB committee (10-11), PolyU SB committee (11-12), PolyU SB President (12-13), YMC member (13-14)

I joined ASHRAE since I was student in Cityu. At the meantime, I though joining a university society is time consuming, but the gain is minimal. My senior pursued me that ASHRAE are a lot of fun and would gain a lot. Here I am, joined ASHRAE, and I had gain more than I could possibly give.



Note: SB – Student Branch, YMC – Young Member Committee, SA – Student Activities, MP – Membership Promotion, CP – Chapter Programs, CTTC – Chapter Technology Transfers Committee, RP – Research Promotion

▶ ASHRAE HONG KONG CHAPTER FUTURE LEADERS



Alan Lam

What is your most unforgettable memory about ASHRAE?

Alex Lui

UST SB President (11-12), YMC member (13-14)

The most unforgettable memory was the ASHRAE CRC and Study tour, it gave me chances to meet friends from other countries; also it is a great experience to participate in the performance team in CRC (Chinese kung-fu!!). That's just a tiny parts of my memories with ASHRAE, and there are still much more than I can write and say.



Iris Li

CityU SB committee (07-08), HKU SB committee (08-09), HKU SB President (09-10), YMC member (11-14), SA Co-Chair (12-13), Reception Committee Chair (13-14)

Haha....I have many unforgettable memories in ASHRAE!! But the most unforgettable memory must be the study tour. I have joined the study tour for three years, where been to Philippines, Thailand and Singapore. In the study tour, I met countless new friends who are from different countries. Until now, we still keep in touch and even go sightseeing together, especially when they come to HK.



Ainsley Chan

HKU SB committee (08-10), YMC member (11-14)

It has to be the ASHRAE's full day technical seminar in Macau. I gain so much knowledge about sustainability which improves the environment. Moreover, I joined others in visiting the new Macau University, which is magnificent. The most important ASHRAE choose me for the event, which I am deeply thankful.



Note: SB – Student Branch, YMC – Young Member Committee, SA – Student Activities, MP – Membership Promotion, CP – Chapter Programs, CTTC – Chapter Technology Transfers Committee, RP – Research Promotion

ASHRAE HONG KONG CHAPTER FUTURE LEADERS



W K Pau

What have you gained from ASHRAE?

Cici Ho

CityU SB committee (08-09), HKU SB committee (09-10), HKU SB President (10-11), YMC member (12-14)

ASHRAE is a platform to enrich my knowledge, to develop my skills, as well as to meet friends. I joined the Study Tours to Thailand, Singapore and Korea which furnish opportunity to explore various technologies and to meet friends among different countries. Being the Student Branch President and YMC committee, I developed soft skills via arranging visits and social activities. I am pleased to join ASHRAE because I gain a lot from ASHRAE.



Wallace Yip

CityU SB committee (05-06), YMC member (07-14), SA Co-chair (13-14)

Even after many years, I can still recall my first flight trip was with ASHRAE's study tour. The study tour, as well as ASHRAE gave more than a chance to handle my student chapter, but also to know peoples from various backgrounds, other, institutions, etc. ASHRAE is the first society I joined in U-life and the only one I am participating since then.



Mandy Wong

CityU SB committee (08-10), CityU SB President (10-11), YMC member (12-14)

I have been a members of ASHRAE family since my first year in University. ASHRAE – which I called “Family” is the place where I always get supports and encouragements. ASHRAE is a platform to explore and develop my talent and abilities, as well as inspires my passion in engineering. Thanks ASHRAE, for lighting up my life!!!!!!



Note: SB – Student Branch, YMC – Young Member Committee, SA – Student Activities, MP – Membership Promotion, CP – Chapter Programs, CTTC – Chapter Technology Transfers Committee, RP – Research Promotion

▶ ASHRAE HONG KONG CHAPTER FUTURE LEADERS



Dr. Chu

What influence has ASHRAE made on you?

Patrick Haung

YMC member (07-14), Publicity Co-chair (08-09), CP Co-chair (11-12), CTTC Co-chair (12-13), SA Chair (13-14)

I joined ASHRAE since 2005 as a Student Member and involved in HKC as a committee member of CityU Student Branch. Then I continued my involvement in HKC after graduated. I joined/organized many activities such as social gatherings, technical talks and site visits which forced me to meet so many new friends and professionals. ASHRAE turned me from a nerd to a sociable person.



Tracy Pang

CityU SB President (03-04), YMC member (05-14), YMC Chair (06-08), SA Chair (08-09), MP Chair (09-10), Treasurer (10-11), Secretary (11-12), President-elect (12-13), President (13-14)

Since joined ASHARE, I took part in numerous overseas meetings and conferences which enhanced my skills in decision making and presentation. The dynamic environment forced me to think outside the box, which is deem important to my career. Moreover, the internationalized ASHRAE trained me for 10 years to speak fluent mandarin and English in the Mainland-HK Joint Symposium and Region XIII events. ^ _ ^



Moka Lai

CityU SB committee (07-09), CityU SB President (09-10), YMC member (11-13), YMC Chair (13-14)

I start joining ASHRAE since 2007 when I was a student committee. At that moment, I do not know how I can act as "an engineer". ASHRAE provides a platform to me to build up my professional. It is not only widen my horizon, it also help me to improve my networking and leadership skill.

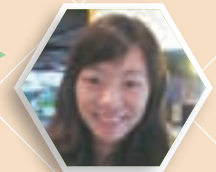

Note: SB – Student Branch, YMC – Young Member Committee, SA – Student Activities, MP – Membership Promotion, CP – Chapter Programs, CTTC – Chapter Technology Transfers Committee, RP – Research Promotion

ASHRAE HONG KONG CHAPTER FUTURE LEADERS



Vincent Chu

What is the future ASHRAE in your mind?

Taylor Chow

CityU SB committee (08-09), PolyU SB committee (09-10), PolyU SB President (10-11), YMC member (11-14), YMC Co-chair (11-12), YMC Chair (12-13), MP Co-chair (13-14)

Excellence, Commitment, Integrity, Collaboration, Volunteerism are the core values from ASHRAE. Every committee follows the above value to serve the society. For the future ASHRAE, We shall keep the core values to serve our member and public, and in addition, 'Globalism'. Globalism allows professionals in different countries cooperate and make ASHRAE the global leader in the engineering industry.



Sabina Cheung

IVE SB committee (04-06), Reception Committee Co-Chair (09-10), Reception Committee Chair (10-11), YMC Chair (11-12), MP Committee Co-Chair (12-13), CP Co-chair (13-14)

At the past 30 years, ASHRAE Hong Kong Chapter focuses on indoor air quality, energy efficiency, refrigeration and sustainability within the building service industry. Every team member has the same target and work closely with each other. At the future, I am sure that our chapter will come together continuously as professionals in our fields not simply to promote our own development and success, but also benefit the industry to promote a public good as a whole.



Joao Wong

HKU SB President (08-09), YMC member (09-14), Reception co-chair (10-11), Newsletter Chair (11-13), RP Co-chair (13-14)

My visions on future ASHRAE are "Diverse", "Energetic", "Adventurous" and "Resourceful". ASHRAE will be a diverse platform for fusion of ideas and culture in different areas and countries, ASHRAE will have energetic members who are willing to drive changes. ASHRAE will be an adventurous society that think differently. ASHRAE will maintain its resourceful image. That's my "DEAR" future ASHRAE.



Note: SB – Student Branch, YMC – Young Member Committee, SA – Student Activities, MP – Membership Promotion, CP – Chapter Programs, CTTC – Chapter Technology Transfers Committee, RP – Research Promotion

ASHRAE Hong Kong Chapter Life



ASHRAE HONG KONG CHAPTER LIFE

Mr. Terry Berrecloth (President 1986-87) presenting certificate of appreciation to Dr. Samuel Wong (President 1985-86)



'86

BOG Meeting



'96

14th Annual General Meeting



'98

ASHRAE/HKIE/CIBSE/HK PolyU Hong Kong Joint Symposium



'98

▶ ASHRAE HONG KONG CHAPTER LIFE

Joint Institutions Mainland-HK Symposium in Shanghai



'99

ASHRAE Night



'00

Region XIII Regional Planning Meeting



'02

Six Thinking Hats Workshop at Retreat



'03

ASHRAE HONG KONG CHAPTER LIFE ◀

BOG Meeting during SARS Period



'03

The 5-S Practice at Retreat



'04

20th Anniversary Organising Chair – Mr. C O Synn

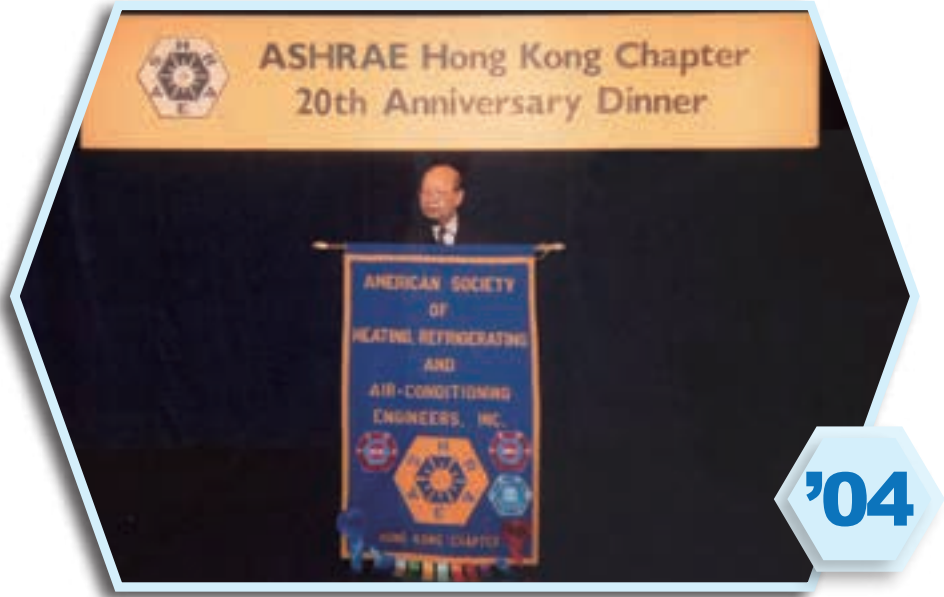

'04

ASHRAE HK Chapter Library



'05

▶ ASHRAE HONG KONG CHAPTER LIFE

ASHRAE President Mr. Terry Townsend Visit HK with Students



'06

Joint Sports Tournament



'06

Annual General Meeting

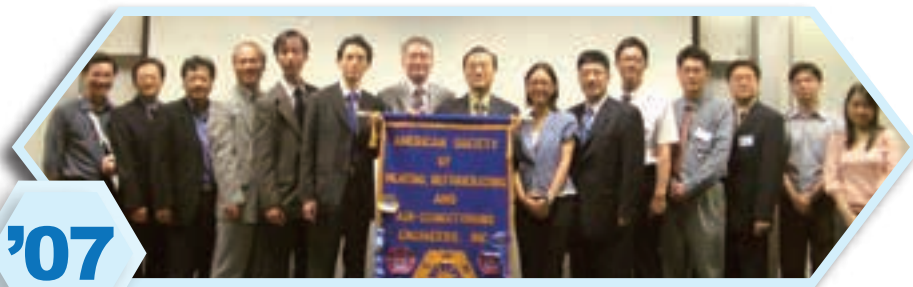

'07

Silver Jubilee Dinner Welcome Speech by Dr. CY Chu



'09

ASHRAE HONG KONG CHAPTER LIFE

Silver Jubilee Dinner



Site Visit to Hong Kong Jockey Club



Joint Student Branch Annual General Meeting



ASHRAE Night



▶ ASHRAE HONG KONG CHAPTER LIFE

SWOT Workshop



'10

LEED Workshop in Macau



'10

CRC in Singapore



'10

The Ladies at CRC Singapore



'10

ASHRAE HONG KONG CHAPTER LIFE

Research Promotion Walk in Lamma Island



'10

Annual Dinner



'11

Retreat



'11

Research Promotion Walk in Tung Ping Chau



'11

▶ ASHRAE HONG KONG CHAPTER LIFE

"COOL Hong Kong" Promotion Campaign



'11

Technical Seminar in Macau



'11

Annual Dinner



'12

ASHRAE Scholarship Presentation



'11

ASHRAE Night



'12

ASHRAE HONG KONG CHAPTER LIFE

CRC in Malaysia



'12

YMC Leather Workshop



'12

Research Promotion Walk in Tai O

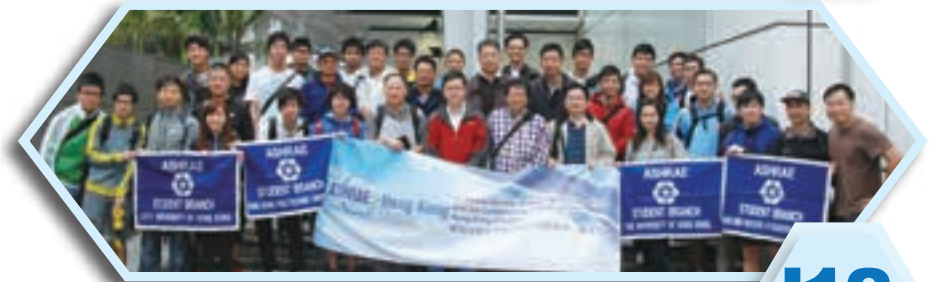

'12

YMC Visit to Ocean Park



'13

Research Promotion Walk in Mai Po Nature Reserve



'13

▶ ASHRAE HONG KONG CHAPTER LIFE

CRC in Indonesia



'13

YMC Latte Workshop



'13

ASHRAE HK Chapter Team at Faminging 30



'13

Joint Student Branch Annual General Meeting



'13

ASHRAE HONG KONG CHAPTER LIFE

War Game



'13

1st BOG Meeting



'14

Inauguration of ASHRAE HK Chapter Organic Farm



'14

ASHRAE Night



'14

Sponsors



“Get serious about energy savings... Get Aircuity!”

Aircuity's Lab Demand Control Ventilation (Lab DCV) solutions make it possible for life sciences facilities to maintain a safe and comfortable working environment while significantly improving energy efficiency.

By reducing the air changes when lab conditions are determined to be clean and increasing the ventilation only when needed, Lab DCV helps to maintain safe and energy-efficient ventilation in research and lab facilities.

In addition to tremendous energy savings, Aircuity provides insight and intelligence about your building's indoor environmental quality (IEQ). Information on IEQ and energy efficiency is right at your finger tips, making troubleshooting, validation and documenting easy. With Aircuity, you can ensure a safe environment for personnel and protect the integrity of the research being conducted.

To learn more contact:



ANWAY ENGINEERING CO., LTD.
正佳工程有限公司
Rm. 2002 Tung Sun Commercial Centre, 194-200 Lockhart Road,
Wanchai, Hong Kong. Tel : (852)2598 4228 Fax : (852) 2802 7494
E-mail: general@anway.com.hk Website:www.anway.com.hk

 **AIRCUITY**[®]
Safe, Smart & Efficient Airside Solutions

Aircuity, Inc. | 55 Chapel Street | Newton, MA 02458 USA | www.aircuity.com | Visit: <http://www.aircuity.com/solutions/industry/life-sciences/>



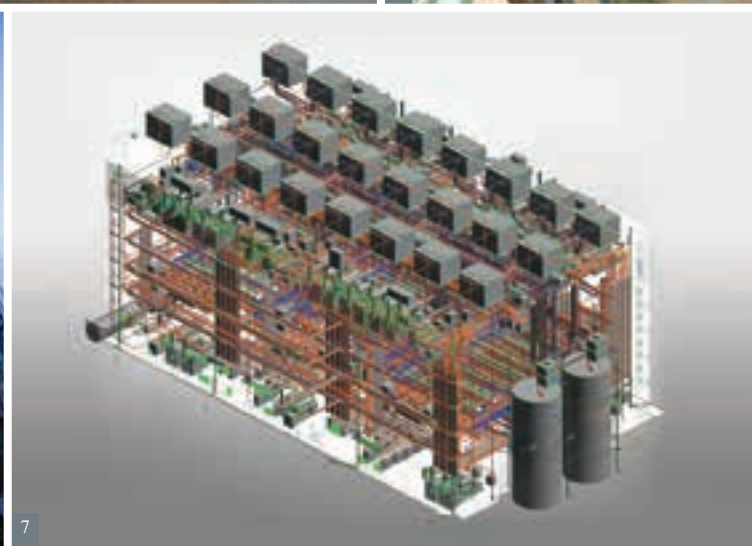

Delivering solutions above expectation

At the forefront of sophisticated use of design tools, Arup delivers innovative systems for built environments that are comfortable for occupants, economic for owners and efficient with resources.

Images

1. Kai Tak District Cooling System, Hong Kong
2. Hong Kong Jockey Club Shatin Communications and Technology Centre
3. Shanghai Oriental Sports Centre
4. Opus Hong Kong
5. Innovation Tower, The Hong Kong Polytechnic University
6. Kingkey 100, Shenzhen
7. Wonder 9 Data Centre, Hong Kong
8. Chongqing International Trade and Commerce Centre

ATAL BUILDING SERVICES

ATAL BUILDING SERVICES ENGINEERING LTD

ATAL BUILDING SERVICES (MACAO) LTD

ATAL ENGINEERING (SHANGHAI) LTD

A member of Analogue Group of Companies



Your Total Solution Provider

ATAL Building Services provides total solution from design, installation, testing & commissioning to maintenance and operation of full spectrum of building services works, including Plumbing & Drainage, Fire, MVAC, Electrical, ELV, Energy Management, Control and Building Management Systems for building and infrastructure projects.

ATAL

13/F, Island Place Tower, 510 King's Road, North Point, Hong Kong

Tel : (852) 2561 8278

Fax : (852) 2565 7638

• Email : atalbs@atalbs.com.hk

• Website : www.atalbs.com.hk



BELIMO Energy Valve™



All-in-one Solution

Five functions in one unit – Measuring, Balancing, Controlling, Data logging & Energy optimisation



WINNER

"2014 AHR Expo Innovation Award" Winner in the Category of Building Automation

One Solution, So Many Benefits

- Smaller Equipment
- Combat Low Delta T
- More Effective Control
- Improved Commissioning
- Better System Maintenance
- Enhanced Energy Optimisation

All-in-one Solution

1. Hydraulic dynamic balancing
2. Air bubble-tight shut-off
3. Pressure-independent flow control
4. Real-time volumetric flow measurement
5. **Energy monitoring, Data logging and BACnet IP or MS/TP Interface**

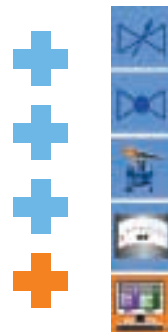

Investment costs comparison - Your added value

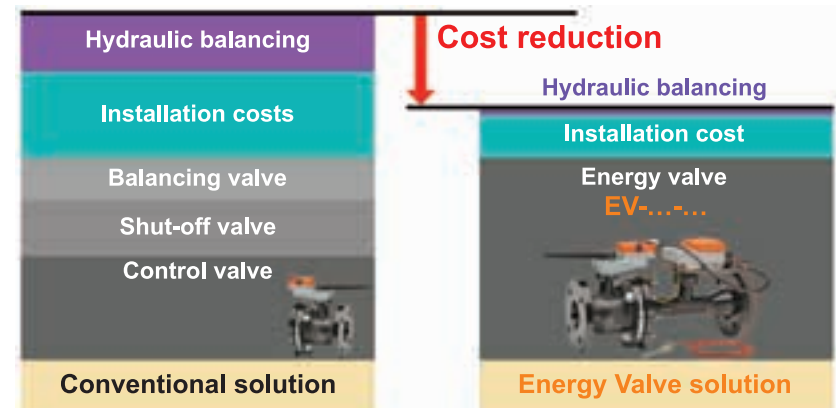



United Technologies
turn to the experts

Carrier AquaFlow™ Variable Water Volume (VWV) System THE BEST OF BOTH WORLDS

Improving upon conventional hydronic and VRF systems to deliver superior comfort and efficiency

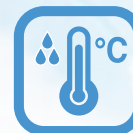

Indoor comfort

Indoor temperature control $\pm 0.5^{\circ}\text{C}$ & Humidity detect control $\pm 5\%^{**}$
Non-stop heating during winter with outdoor unit sequential defrosting
No risk of indoor refrigerant leakage



High efficiency

Inverter with Grade 1 energy efficiency (China GB)
System IPLV 40% higher than traditional hydronic systems & 10% higher than VRF**

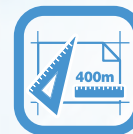

Flexible design

Max. 114HP, combining up to 8 modules
Connecting pipe length 400 m and 100 m height difference
Optional hydronic kit matching unlimited pipe length***
No indoor unit height difference limit



Powerful control

Manage whole HVAC system
Self adaptive variable water flow & temperature control
Energy management & building automation control connection readiness

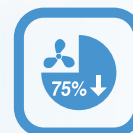

Smart fresh air

100% fresh air at 25% of conventional ventilation cost**
Heat recovery fresh air unit
Demand control ventilation (CO₂ control)

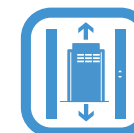

Easy installation

Compact footprint of 0.3 sqm
Ease of piping and wiring connection
Factory assembly valves & controller on indoor unit

Versatile applications



Villas

Shopping malls

Office buildings

Hotels

* Self adaptive variable water temperature / Self adaptive variable refrigerant evaporating temperature

** Based on Carrier studies

*** Assuming optimal hydronic module heads

Copyright © 2014 Carrier

Carrier Hong Kong Limited

10/F, Octa Tower, 8 Lam Chak Street, Kowloon Bay, Hong Kong
Telephone: (852) 2694 5333 Fax: (852) 2691 2642
Website: www.carrier.com.hk

Flow*Mate*

Wonderball

contact us @

Tel: +(852)-23014868
www.intelligent-technologies.com

Bioclimatic
Air Systems

MITSUBISHI
HEAVY INDUSTRIES

We share the same
GREEN building dream



Intelligent Technologies

Parsons Brinckerhoff
Congratulates
ASHRAE Hong Kong Chapter
on its **30th** Anniversary



Creating a better future, today

Linkey™

*The Total Building Management Software
Solution designed by software and
engineering professionals*

Linkey system is proudly developed in Hong Kong. It provides software solutions for facility and drawing management of a building or real estate. The users comprise the building owners, estate management offices, architect firms, building services consultants, project managers, contracting firms, etc.

Linkey system comprises different Managers below:-

CAD Manager

Project Manager

Drawing Manager

Space Manager

Maintenance Manager

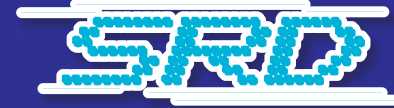

SRD Computing & Engineering Co., Ltd.

B7-B8, 6/F., Po Yip Bldg., 62-70, Texaco Rd., Tsuen Wan, Hong Kong

Tel : (852) 2598 6631 Fax : (852) 2598 5131 Website : www.srd.com.hk

Towngas

Your Green Energy Solution of Choice



More Safe

More Economical

More Powerful

More Hygienic

More Environmentally-friendly

Towngas, the best partner for one-stop energy solutions for all restaurant, hotel & recreation, hospital & community, food processing and industrial businesses. Safer, more economical, more powerful and more hygienic than any other energy supply. For greater competitiveness and bluer skies, choose Towngas, the only way to ignite business success!



煤氣
Towngas

Commercial & Industrial Marketing and Sales Department
The Hong Kong and China Gas Company Limited
Commercial & Industrial Customer Hotline: 2963 3300
Website: www.towngas.com

 **IGNITING**
your business success

High Efficiency Inverter Systems

Adaptable Design

Trane's new design can blend in with any interior decoration. The operation panel shows five functional icons.

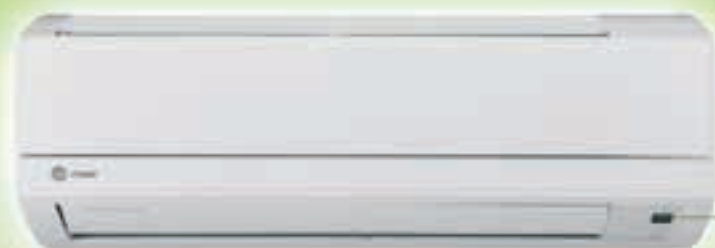

Key Features

- Single split unit with inverter compressor
- R410A environmental friendly refrigerant
- Superior efficiency (up to COP 3.3)
- Turbo mode for rapid cooling
- Quiet operation, noise level as low as 25dB(A)

(Indoor sound level for 1 Hp & 1.5 Hp measured at low speed)

User-friendly Remote Controller



- Large display
- Easy operation
- Immediate response



For technical information, please refer to Trane Product Catalogue.



Trane Hong Kong
A division of TYS Limited

12/F., Manhattan Centre, 8 Kwai Cheong Road, Kwai Chung, New Territories, Hong Kong
Tel.: (852) 3128 4711 Fax: (852) 2887 9111
Website: www.tranehk.com E-mail: thk@jec.com

Jointly owned by Jardines and Trane





Eaxon International Company Limited 恩索有限公司
Eaxon Environmental Technology Co. Ltd. 恩索環保科技有限公司



Air Purification System

空氣淨化設備

*Cleaning the air where
you live, work, play
and breath*



KLINGENBURG

Thermal Wheels

轉輪熱交換器

*Energy saving and CO2
reduction can be achieved
in an ideal way through
heat recovery*

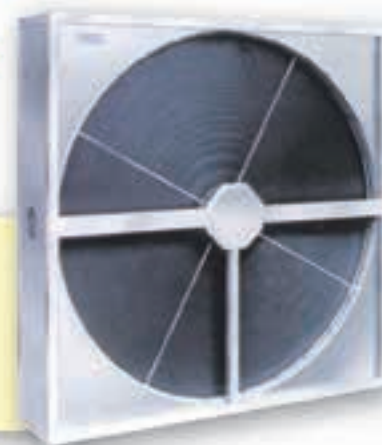

Air Filtration Products

空氣過濾器

*Your partner for managing
IAQ improvement
Commercial, Industrial &
Hospital applications*



SPIROTECH
FOR BETTER PERFORMANCE

冷/熱水自動除氣/除污器



*Removes circulating
air and micro bubbles,
dirt effectively*

香港辦事處 Hong Kong Office

香港九龍觀塘開源道48號威利廣場808室

Unit 8, 8/F, Westley Square, 48 Hoi Yuen Road, Kwun Tong, Kowloon.

電話 Tel: (852) 3590 4656

傳真 Fax: (852) 2566 1321

E-mail: info@eaxon.hk

Lucky-PIP® Pre-insulated Pipe



LUCKY-PIP® Pre-Insulated Pipe

is an environmental friendly material widely used in government and commercial projects. The product consists of a carrier pipe, insulation and outer jacket. The carrier pipe and outer jacket are available in a variety of sizes and materials, as well as different insulation thickness.

We Supply High Quality Pre-insulated Pipe to All Prestigious Projects in Hong Kong

“必發”保溫喉遍及香港各重要工程項目

Link The Best Company Limited

Unit 8, Industrial Park, No. 188 Tai Po Tin, Ping Che, Fanling, NT, Hong Kong

Tel: (852) 2568 4092

Fax: (852) 2423 7829

E-mail: sales@linkthebest.com.hk

Website: www.linkthebest.com.hk



Sustaine

Air to Water Heat Pump
Water to Water Heat Pump
Swimming Pool Heat Pump
Total Energy Heat Pump
Desiccant Dehumidifier
Split-type Heat Pump
Energy Recovery Ventilator



Options available

- Double Wall
- Titanium tube



Major Project Reference

- Kwun Tong Public Swimming Pool
- Tuen Mun Northwest Public Swimming Pool
- Tung Chun Public Swimming Pool
- Ocean Park
- Hang Seng Management School
- Hong Kong Sport Institute
- Ko Shan Theatre
- Tseung Kwan O Sport Centre
- Macpherson Indoor Stadium
- Cathay Pacific Airways
- HSBC Data Centre, Shek Mun
- Disney's Hollywood Hotel
- Cosmopolitan Hotel
- Wharney Guangdong Hotel
- Hong Kong University
- Diocesan Girl School
- Dundas Street Hotel Development

Sustainable Energy Ltd

Tel: 852-23323077; Fax: 852-37644783; e-mail: info@sustaine.com.hk; www.sustaine.com.hk



Delta releases your lock from proprietary systems:

- Delta System opens up the engineering tools for you.
- Delta will train your engineers to engineer your system.
- You will have the freedom to choose your maintenance service provider.

**We open up to the very end.
You become the true driver on your Building Management System.**

With Delta, you control your destiny.

Delta Controls' Reputable Projects in Hong Kong



Australian Expo
HONG KONG INTERNATIONAL AIRPORT
Points: 10,000+

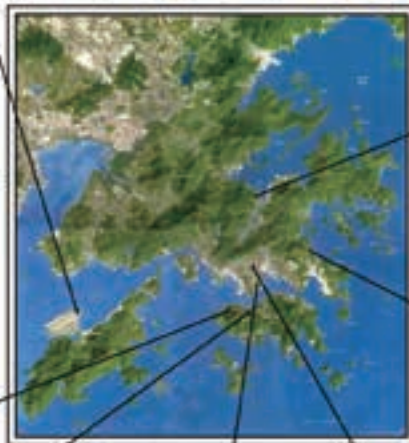

The Chinese University of Hong Kong
Points: 10,000+



The University of Hong Kong
Points: 1,000+



The Hong Kong University of Science and Technology
Points: 9,000+



Mandarin Oriental Hotel Hong Kong
Points: 4,000+



The Hong Kong Polytechnic University
Points: 12,000+



The City University of Hong Kong
Division of Building Science and Technology
BACnet Integration
Points: 1,000+

Contact us:

Phone: +852 2884 9001

Fax: +852 2884 9003

Email Address: info@hensen.com.hk



Jardine Engineering Corporation (JEC) is a leading provider of products and services that engineer a better Asia. The group provides products and sourcing, engineering contracting, and technical services for buildings, the energy and transport sectors, and environmental infrastructure.

Established in Shanghai in 1923, JEC is now headquartered in Hong Kong and operates throughout Asia. JEC is the member of the Jardine Matheson Group.

Jardine Engineering Corporation

Hong Kong Headquarters
5/F Tower A Manulife Financial Centre
223-231 Wai Yip Street Kwun Tong
Kowloon Hong Kong
Tel 852 2807 1717
Fax 852 2887 9090
Email jec@jec.com
www.jec.com

 A member of the Jardine Matheson Group



Air Filter



Variable Speed Drive



Gas Filter



Air Purifier



Automatic Backwash Strainer



Arnhold & Co., Ltd.
t: (852) 2807 9400 | f: (852) 2806 1744 | e: arnhold@arnhold.com.hk | www.arnhold.com.hk

Congratulations to the 30th Anniversary Celebration of ASHRAE Hong Kong Chapters!



The GEES Group:



A Business Consortium Driving Solutions for a Green Future



Problem Solvers
in Vibration Isolation,
Noise and Shock Control
Members of ASHRAE, AMCA,
VISCMA, ASME, CSME, HKIOA,
AIA & ACRA

Duct Laggings Barrier Materials



Model KNM-100ALQ



Model KBC

Suspended Vibration Isolators



Model SHAA
Isolation Hanger



'SPRH' Isolation Hanger
with Safety Control Device

Floor Mounted Vibration Isolators



Model FDS
Free Standing



Model FLS
Restrained Type



New Way Engineering Co., Ltd.

新法機械有限公司

HORIZONTAL AND VERTICAL
AXIALLY SPLIT CASING PUMPS



HORIZONTAL
SPLIT CASING PUMP

ap AURORA
Product Range



Filternox
AUTOMATIC SELF-CLEANING FILTERS



FITERNOX AUTOMATIC SELF
- CLEANING FILTER

SIEMENS



FREQUENCY INVERTER

NSV



VIBRATION ISOLATORS



Kinetics Noise Control (Asia) Ltd.

Unit E, 9/F., World Tech Centre, 95 How Ming Street, Kwun Tong, Hong Kong
Tel: (852) 2191 2488 Fax: (852) 2191 2477 Email: hksales@kineticsnoise.com

Address :

Flat F, 22/F., Luk Hop Ind. Bldg., 8 Luk Hop St.,
San Po Kong, Kowloon, Hong Kong.

Website : www.newway.com.hk
Tel : 2325 6892 Fax : 2322 1768

Pure Air. Real Science.™

STERIL-ZONE / MODEL RSV-SZC 600/SZ-201

Steril-Zone Germicidal Air Sterilizer 600CMH

For Maximum Indoor Air Quality - Steril-Zone Ceiling Mounted Unit with wireless remote controller

Application

Airport security areas, hospitals, schools, homes, conference rooms, offices, IT centers, call-centers, banks, restaurants, hotels & food processing areas.

Benefits

Reduces asthma, allergies, spread of infectious diseases, odors, VOCs, cigarette smoke.



Pollutant Class	Typical Examples	Steril-Zone Component
Particulates	Dust, pollen, pet danders, some mold microorganisms	99% efficiency particulate air filter at 0.3 micron
Volatile organic compounds (VOC)	Smoke, pet and human odors, cooking fumes & odors, marijuana, chemicals	Patented extended-life activated carbon filter
Microorganisms	Viruses, bacteria and mold	Patented germicidal UVC light™



The Professional Germicidal UVC Air Sterilizer



RSI ROYAL VAV



COMPLETE LINE VAV
BOX & CONTROLS

www.royalservice.com.cn

惠生電業有限公司

C.J. WISHING INTERNATIONAL LTD.

TEL: 2799 9797 FAX: 2796 5257

Website: www.cjwish.com.hk



SOUTHA 南龍集團 GROUP



Certificate No. CC-100 (MCD&S) Issued by
ISO 9001 & ISO 14001 2004
Certificate No. CC 99
OHS&S 14001-2007
Certificate No. CC 071
ISO 9001:2015



Hong Kong Architecture



North Lantau Hospital



Customs Headquarters



Star Museum



Shek Ai Ma Factory



Investment Office



111 Bank Center

Specialist Contractor for

HVAC
Industrial Refrigeration
Incinerator and Cremator
Boiler and Steam Plant
Plumbing and Drainage

Electrical Installation
Cold Store & Ice Rink
Mechanical Plant
Commercial Catering
Environmental Engineering

Fire Services Installation
BMS & Security
Laundry
Air Treatment
Automatic Refuse Collection

香港樂善堂街十二號百樂門大廈七樓

7/F Paramount Building, 12 Ka Yip Street, Chai Wan, Hong Kong
Tel: (852) 29637122 Fax: (852) 2963 7101 Email: mail@southa.com Website: <http://www.southa.com>

Congratulations to
ASHRAE HONG KONG CHAPTER
on its 30th Anniversary

With the Compliments of



滙智機電顧問有限公司
Talent Mechanical & Electrical Engineers Ltd.

Unit 203, 2/F, Dominion Centre, 43-59 Queen's Road East, Wanchai, Hong Kong

Tel : (852) 2838 9133 Fax : (852) 2836 0750

Email : info@talentme.com

Website : <http://www.talentme.com>

Hong Kong • Beijing • Shanghai • Shenzhen • Chengdu



特立美環保及能源管理有限公司

Telex Environment and Energy Management Limited



Energy

Electrical &
Mechanical

Green Building

Environment

Hong Kong • Macau • China

Tel : (852) 3563 7003 Fax : (852) 3563 7018

Website : www.telexeem.com





ACKNOWLEDGEMENTS ◀

Diamond Sponsor: *(in alphabetical order)*

Anway Engineering Company Limited
ARUP
ATAL Building Services Engineering Limited
Belimo Actuators Limited
Carrier Hong Kong
Intelligent Technologies Limited
Parsons Brinckerhoff (Asia) Limited
SRD Computing & Engineering Company Limited
The Hong Kong and China Gas Company Limited
Trane Hong Kong

Jade Sponsor: *(in alphabetical order)*

Hensen System Engineering Limited
The Jardine Engineering Corporation, Limited

Table Sponsors: *(in alphabetical order)*

Alliance Contracting Company Limited
Bonrich Engineering Limited
Bun Kee (International) Limited
Cold Magic Efatar (HK) Company Limited
Dynamic Success Company Limited
Ever Cool Refrigerating & Air Conditioning Company Limited
FSE Engineering Group Limited
Johnson Controls Hong Kong Limited

Kai Shing Management Services Limited
Kings View Airconditioning Engineering Company Limited
Lek Pou Engineering Company Limited
McQuay Air-conditioning Limited
Ryowo (Holding) Company Limited
Schneider Electric (Hong Kong) Limited
Shinryo (Hong Kong) Limited
Skyforce Engineering Limited
Standard Refrigeration and Engineering Company Limited
Takasago Thermal Engineering (Hong Kong) Company Limited
The Chartered Institution of Building Services Engineers, Hong Kong Branch
The Hong Kong Institution of Engineers, Building Services Division
Wardson Engineering Limited
Welcome Air-Tech Limited
Westco Chinney Limited

Sponsors on Brochure: *(in alphabetical order)*

Arnhold & Company, Limited
Eaxon Environmental Technology Company Limited
GEES Tech Limited

Kinetics Noise Control (Asia) Limited
Link The Best Company Limited
New Way Engineering Company Limited
Royal Services Air Conditioning Corporation
Southa Technical Limited
Sustainable Energy Limited
Talent Mechanical & Electrical Engineers Limited
Telemax Environmental and Energy Management Limited

Red Wine Sponsor:

Yip Tong Kee Company Limited

This book is produced by Creative Consulting Group Inc. Limited.

Website:

<http://www.ashrae.org.hk>

Email: info@ashrae.org.hk

Corresponding Address:

P.O. Box 35612, King's Road Post Office,
North Point, Hong Kong



ASHRAE Hong Kong Chapter
美國供暖製冷及空調工程師學會
香港分會

All Rights Reserved 2014.



Printed on Recycled Paper

ISBN 978-988-12980-0-3